

JUL-SEP 2024



SUPERIOR ABRASIVES

SHUR-BRITE® Surface Conditioning Discs

Finish Duty (F.D.) products enable the operator to prepare the workpiece with a required surface finish.

FEATURES:

- Added flexibility.
- Maintain a repeatable measured finish.
- Provides a consistent cut rate.

Type "R"

APPLICATIONS:

- Blending
- Deburring
- Scale Removal
- Rust Removal
- Stock Removal
- Weld Splatter Removal



Finish Duty Quick Change Discs

Size	Grit	Color	Part No.	Reg. Net Price/Ea.	SALE!
2" 50/box	Coarse	Brown	1-613-10553	\$2.42	\$2.18
	Medium	Red	1-613-10554	2.33	2.10
	Very Fine	Blue	1-613-10555	2.33	2.10
3" 25/box	Coarse	Brown	1-613-10556	4.33	3.90
	Medium	Red	1-613-10557	4.07	3.66
	Very Fine	Blue	1-613-10558	4.07	3.66

**STRONGER
QUICKER
RELIABLE
LONGEVITY**

SHOP IRON

Welding Cart

FEATURES:

- Designed to store and transport most MIG and plasma machines, shielding gas tanks and other welding equipment and accessories.
- Tilted top shelf allows access to welder controls.
- Additional shelves for storing accessories.
- Side hooks for torch and cable storage.
- Heavy duty molded rear wheels.

Part No. 1-701-41197 **\$161²⁸**
Reg. Net Price \$215.04

save 25%



airmaster

Quality You Can Feel

NEW!

Low Stand Pivot Fans

360° Adjustable Non-Oscillating

FEATURES:

- Includes chrome yoke mount.
- Meets OSHA regulations.
- Nickel chrome guards and aluminum propellers.
- Totally enclosed motor both mounts in same box.
- Pull chain switch with 10' three conductor cord and plug.
- 115V, 1 Phase, 3 speed, totally enclosed, ball bearing motor.



UL US

Blade Size	CFM			HP	Part No.	Reg. Net Price	SALE!
	High	Medium	Low				
12"	1855	1550	1300	1/16	1-822-78985	\$200.13	\$170.11
18"	4550	3824	3346	1/8	1-822-78984	251.17	213.49

Mitutoyo

Quill Kit

With ABSOLUTE Encoder

FEATURES:

- Push button controls for inch/mm, zero-set and on/off.
- Easy to read LCD with resolution of .0005" (0.01mm). 0-5" travel inch/mm.
- Powered by a single SR-44 battery lasting about 1 year with normal use.
- SPC Output for data transmission to data processors or a remote display.

save 20%

Easy installation fits most vertical knee mills.



Part No. 1-808-053906 **\$347²⁰**
Reg. Net Price \$434.00

Starrett 0-6" Electronic Slide Caliper

Supplied in a protective case.

save over 20%



FEATURES:

- Integrated depth rod.
- Linear accuracy meets DIN862.
- Auto shut-off after 5 minutes on non-use.
- Zero at any position.
- Large easy-to-read LCD with .32" high characters.
- Last measuring position retained when shut off.
- Fine adjustment thumb wheel.
- Lock screw to hold the slide position.
- Hardened stainless steel body for long life.

SPECIFICATIONS:

Resolution0005" (.01mm)
Accuracy ±.0015" (.04mm)

Starrett No. EC799A-6/150

Part No. 1-855-00142 **\$199⁰⁰**
Reg. Net Price \$259.00



BAXTER VERTICUT INC.
BANDSAW MACHINES

General Purpose Gravity Feed Vertical Bandsaws

3/4 HP, 115V, 1 PH

FEATURES:

- Foot pedal for hands free carriage movement of 4" (100mm).
- Roller guides are hardened and grooved allowing use of 1/4", 3/8", 1/2", and 3/4" (6.4, 9.5, 12.7, 19mm) blades without any adjustment.
- Ground solid steel table (18" x 30") and cast iron wheels.
- Electric system uses only C.S.A./UL approved components and is electrically approved.

Includes FREE

Stop Set
\$299 Value!
While Supplies Last.



SPECIFICATIONS:

Cutting Capacity (height x width)... 13" x 9"
Blade Size 120" x 1/4" x 3/4"
Maximum Blade Travel..... 9"

AS LOW AS \$134.83/mo.

Model 115C
Blade Speeds:
(4) 75, 130, 215, 350 SFPM

Part No. 6-600-115C
\$5,969⁰⁰

Model 115C-VS
Blade Speeds: (Variable Speed) 70 to 350 SFPM

Part No. 6-600-115C-VS
\$7,642⁰⁰



WEB: **KBCTools.com**

PHONE: **1-888-KBC-TOOL**

M-F 8am - 8pm, EST

FAX: **1-800-668-5615**

FAX ORDERS 24/7

- Cutting Tools 2-6
- Carbide Tooling 7, 28
- Fluids 25, 28
- Workholding Tools 8-9
- Abrasives 1, 10-11
- Measuring & Inspection 1, 12-15
- Toolroom Accessories 24, 28
- Hand Tools 26
- Shop Supplies 1, 22-23
- Power / Air Tools 27, 28
- Machinery 1, 16-21

100% SATISFACTION GUARANTEED:

If you are not 100% satisfied for any reason just return the unused item(s) in its original packaging within 30 days, with your receipt for a replacement, exchange, full credit or refund.



FREE SHIPPING:

Orders over \$449.00 (50 lbs. weight limit per order) SHIPPED FREE - via our standard shipping method. Some restrictions may apply.

99% of All Orders Ship the Same Day... Or you can Pick Up at your Local Branch.* Your Choice.



* Excludes Machinery & Non-Stock Items.

DAMAGED, LOST, OR SHORT SHIPMENTS:

It doesn't happen often, but if it does, call your local courier office immediately, and advise KBC so that we can reship and place a claim. Please keep damaged goods and containers until the claim is closed.

TRUCK SHIPMENTS:

KBC is not responsible for merchandise damaged or lost by motor freight carriers. If the shipment is damaged or short one or more packages, please have it noted by the truck driver on receipt and freight bill. If you accept a short or damaged shipment from the truck driver without proper notation by the driver, you do so at your own risk.

PRICING:

KBC Tools & Machinery traditionally holds prices for the duration of its sales flyers. As industrial market conditions continue to change across North America (tariffs, raw material, and price increases), KBC reserves the right to change prices based upon inventory conditions and supplier price increases without notice. BUY NOW! KBC Tools & Machinery strives to be your choice for all your tooling needs.

MINIMUM ORDER:

Only \$25.00, to cover processing costs.

OOPS!:

Errors do occur, so mistakes are subject to correction. Sorry for any inconvenience.

GSA Contract #BPA-GS-06F-4KBC7

Industrial Metalworking Tooling & Solutions Since 1965

Milwaukee 38 Pc. Tap & Die Sets PACKOUT™ Set with Hex-Lok™ 2-in-1 Handle

FEATURES:

- Hex-LOK™ 2-in-1 handle is the most versatile threading solution designed for tap and die threading.
- Hex-LOK™ 2-in-1 handle is compatible with 1" hex dies & MILWAUKEE® tap collet.
- 2-in-1 handle compatibility allows for easy snap in and out, tool-free die and collet changes.
- Taps and dies feature long lasting laser etch for the clearest markings.
- Black oxide coated taps and dies for corrosion resistance.
- Plug style tap is designed for through hole threading.
- Hex dies can be used to create or repair threads.
- Designed for use in metal materials including brass, aluminum, mild steel, and more.
- Hand taps are not recommended for use with power tools.
- Includes accompanying drill bits for pre-drilling holes.
- Drill bits are designed for use with drill drivers.
- For best results use with cutting fluid.
- The set is organized in a PACKOUT™ low-profile compact organizer and includes a removable storage tray.



Metric Set Shown

SAE Set Shown

METRIC SET INCLUDES:

- (1) 0.35-3.00mm Metric Thread Pitch Gauge.
- Straight Flute Plug Tap (1 each): M3x0.50, M4x0.70, M4x0.75, M5x0.90, M5x0.80, M6x1.00, M7x1.00, M8x1.25, M8x1.0, M9x1.25, M9x1.00, M10x1.50, M10x1.25, M11x1.50, M12x1.50, M12x1.75
- (1) 1/8"-28 BSP Straight Flute Taper Tap
- 1-Inch Hex Threading Die (1 each): M3x0.50, M4x0.70, M5x0.90, M5x0.80, M6x1.00, M7x1.00, M8x1.25, M8x1.00, M9x1.25, M10x1.50, M10x1.25, M11x1.50, M12x1.75, M10x1.50
- (1) Tap Collet.
- (1) Sliding T-Handle.
- (1) Hex-LOK 2-IN-1 Handle.

Metric Part No. 1-828-49225603
\$240⁰⁰

INCH SET INCLUDES:

- (1) 8-44 TPI SAE Thread Gauge.
- Straight Flute Plug Tap (1 each):
- National Course: 4-40, 6-32, 8-32, 10-24, 12-24, 1/4"-20, 5/16"-18, 3/8"-16, 7/16"-14;
- National Fine: 10-32, 1/4"-28, 5/16"-24, 3/8"-24, 3/8"-24, 1/2"-20, 1/8"-27 NPT
- 1-Inch Hex Threading Die (1 each):
- National Course: 4-40, 6-32, 8-32, 10-24, 12-24, 1/4"-20, 5/16"-18, 3/8"-16, 7/16"-14, 1/2"-13;
- National Fine: 10-32, 1/4"-28, 5/16"-24, 3/8"-24, 7/16"-20, 1/2"-20, 1/8"-27 NPT
- (1) Tap Collet.
- (1) Sliding T-Handle.
- (1) Hex-LOK 2-IN-1 Handle.

SAE Part No. 1-828-49225604
\$240⁰⁰

CLARKSON/OSBORN Blue Wizard Spiral Pointed Taps

Premium Taps that Customers Ask for by Name.

HIGH SPEED STEEL
GROUND THREAD RIGHT HAND

A spiral point tap with blue surface finish for through holes in mild steel, malleable iron and difficult to machine materials, such as stainless steel and high alloyed metals.

MADE IN ENGLAND 1/4" - 2 Flute
FRACTIONAL SIZES 5/16" & Up - 3 Flute

Size	Ground Thread Limits	Part No.	Reg. Net Price	SALE!
1/4-20 NC	H3	1-361A-0161	\$14.60	\$12.41
5/16-18 NC	H3	1-361A-0201	15.72	13.36
3/8-16 NC	H3	1-361A-0241	21.26	18.07
1/2-13 NC	H3	1-361A-0321	31.32	26.62

Stock Up To Save Big! 10 Per Pack

7 Pc. Solid Cap Screw Counterbore Set

3 FLUTE STRAIGHT SHANK HIGH SPEED STEEL

FEATURES:

- Designed to create a recess for socket head cap screws and shoulder screws.
- Solid pilot will not score or damage pilot hole.
- Cutting action is chatterless.
- Also used for spot facing smaller spots, enlarging, or cleaning holes.

Sizes: 6, 8, 10, 1/4", 5/16", 3/8", 1/2"

Part No. 1-166-400

Reg. Net Price \$239.44

\$191⁵⁵

save 20%



Niagara 4 Flute Corner Radius Cutter Center Cutting End Mills

List C430R

FEATURES:

- General purpose end mills are ideal for most milling applications.
- Ultra-high transverse rupture strength.
- Full CNC ground.
- Radius tolerance ±.002.
- Extra-fine grade carbide.

Mill Dia.	Shank Dia.	Length of Cut	OAL	.015 Radius			.020 Radius			.030 Radius		
				Part No.	Reg. Net Price	NOW!	Part No.	Reg. Net Price	NOW!	Part No.	Reg. Net Price	NOW!
1/8"	1/8"	1/2"	1-1/2"	5-431-91372	\$36.55	\$29.24	5-432-91373	\$36.55	\$29.24	5-433-91374	\$36.55	\$29.24
3/16"	3/16"	5/8"	2	5-431-91375	45.72	36.58	5-432-91376	45.72	36.58	5-433-91377	45.72	36.58
1/4"	1/4"	3/4"	2-1/2"	5-431-91378	62.47	49.98	5-432-91379	62.47	49.98	5-433-91380	62.47	49.98
5/16"	5/16"	13/16"	2-1/2"	5-431-91382	87.10	69.68	5-432-91383	87.10	69.68	5-433-91384	87.10	69.68
3/8"	3/8"	1"	2-1/2"	5-431-91386	101.59	81.27	5-432-91387	101.59	81.27	5-433-91389	101.59	81.27
7/16"	7/16"	1"	2-3/4"	5-431-91391	118.82	95.06	5-432-91392	—	—	5-433-91393	118.82	95.06
1/2"	1/2"	1"	3"	5-431-91353	172.27	137.82	5-432-91398	172.27	137.82	5-433-91399	172.27	137.82



save 20%



Carbide Tipped UNI-PLUS® Masonry Drills



Used for drilling in concrete, brick, ceramic, tile, marble, fiberglass, metal, wood, and plastic.



Size	OAL	Shank Dia.	Part No.	Reg. Net Price	SALE!
5/32"	3-1/4"	5/32"	1-010-041	\$14.94	\$11.95
3/16"	3-1/4"	3/16"	1-010-042	10.09	8.07
1/4"	4"	1/4"	1-010-043	10.55	8.44
5/16"	4-3/4"	5/16"	1-010-045	12.21	9.77
3/8"	4-3/4"	3/8"	1-010-046	15.26	12.21
1/2"	6"	1/2"	1-010-047	29.78	23.82

10 Pc. Solid Carbide Miniature Burr Set Standard Cut

Part No. 5-100-71049
Reg. Net Price \$175.69

\$149³⁴

FEATURES:

- Head Diameter: 1/8"
- Shank Diameter: 1/8"
- Overall Length: 1-1/2"

SET INCLUDES:

- SA-43, SC-42, SC-41, SD-42, SE-41, SF-41, SG-41, SM-45, SL-42, SN-42



25 Pc. Assorted Carbide Burr Set With 1/8" Shanks

SET INCLUDES:

- SA-41 (1/16 x 1/4")
- SA-42 (3/32 x 7/16")
- SA-43 (1/8 x 9/16")
- SB-43 (1/8 x 9/16")
- SC-41 (3/32 x 7/16")
- SC-42 (1/8 x 9/16")
- SD-41 (3/32")
- SD-42 (1/8")
- SE-41 (1/8 x 7/32")
- SF-41 (1/8 x 1/4")
- SF-42 (1/8 x 1/2")
- SG-41 (1/8 x 1/4")
- SG-42 (1/8 x 5/16")
- SG-43 (1/8 x 3/8")
- SH-41 (1/8 x 1/4")
- SJ-41 (1/8 x 3/32" 60° included taper)
- SK-41 (1/8 x 1/16" 90° included taper)
- SL-41 (1/8 x 3/8" 14° included taper)
- SL-42 (1/8 x 1/2" 14° included taper)
- SM-41 (1/8 x 3/8" 12° included taper)
- SM-42 (1/8 x 7/16" 14° included taper)
- SM-43 (1/8 x 5/8" 7° included taper)
- SN-41 (3/32 x 1/8" 10° included taper)
- SN-42 (1/8 x 3/16" 10° included taper)



Part No. 1-336-000
Reg. Net Price \$207.09

\$176⁰³



118° POINT
RIGHT HAND
HIGH SPEED STEEL

PRECISION 3-In-1 Jobber Drill Set

Jobbers length drills are designed to perform in a wide variety of normal conditions and in a broad range of materials in both machine and portable drilling.

1/16" to 1/2" by 64ths, No. 1 to No. 60 & A to Z

Part No. 1-001A-0115
Reg. Net Price \$970.74



\$776⁵⁹

CLE-LINE Left Hand Jobber Drills



118° POINT
21° TO 34° HELIX
STRAIGHT SHANK
HIGH SPEED STEEL
FRACTIONAL SIZES

FEATURES:

- For general purpose drilling and maintenance applications.
- Left hand helix for jobbers length applications where adjacent spindles operate alternately.

PRECISION Cobalt Jobber Drills

For drilling tough, high tensile strength materials. Heat resistant 8% cobalt and heavy-duty flute construction.



HIGH SPEED STEEL 135° SPLIT POINT RIGHT HAND

Size	OAL	Part No.	Reg. Net Price	NOW!	Size	OAL	Part No.	Reg. Net Price	NOW!
1/16"	1-7/8"	1-011A-004	\$5.16	\$4.39	19/64"	4-3/8"	1-011A-019	\$19.00	\$16.15
5/64"	2"	1-011A-005	5.16	4.39	5/16"	4-1/2"	1-011A-020	20.10	17.09
3/32"	2-1/4"	1-011A-006	5.16	4.39	21/64"	4-5/8"	1-011A-021	22.34	18.99
7/64"	2-5/8"	1-011A-007	5.44	4.62	11/32"	4-3/4"	1-011A-022	24.36	20.71
1/8"	2-3/4"	1-011A-008	6.56	5.58	23/64"	4-7/8"	1-011A-023	28.30	24.06
9/64"	2-7/8"	1-011A-009	6.62	5.63	3/8"	5"	1-011A-024	27.89	23.71
5/32"	3-1/8"	1-011A-010	7.41	6.30	25/64"	5-1/8"	1-011A-025	32.01	27.21
11/64"	3-1/4"	1-011A-011	7.86	6.68	13/32"	5-1/4"	1-011A-026	33.20	28.22
3/16"	3-1/2"	1-011A-012	8.76	7.45	27/64"	5-3/8"	1-011A-027	36.87	31.34
13/64"	3-5/8"	1-011A-013	10.56	8.98	7/16"	5-1/2"	1-011A-028	37.66	32.01
7/32"	3-3/4"	1-011A-014	11.57	9.83	29/64"	5-5/8"	1-011A-029	45.48	38.66
15/64"	3-7/8"	1-011A-015	12.27	10.43	15/32"	5-3/4"	1-011A-030	46.33	39.38
1/4"	4"	1-011A-016	12.96	11.02	31/64"	5-7/8"	1-011A-031	47.76	40.60
17/64"	4-1/8"	1-011A-017	14.82	12.60	1/2"	6"	1-011A-032	46.94	39.90
9/32"	4-1/4"	1-011A-018	15.57	13.23					

DORMER TiN Coated Jobber Drills

RIGHT HAND
HIGH SPEED STEEL
TIN TIPPED 118° POINT



Jobbers length drills are designed to perform in a wide variety of normal conditions and a broad range of materials in both machine and portable drilling. Superhard TITANIUM NITRIDE (TiN) surface treatment improves drill life, chip ejection, and productivity; decreases horsepower requirements.

Size	OAL	Part No.	Reg. Net Price	SALE!	Size	OAL	Part No.	Reg. Net Price	SALE!
3/32"	2-1/4"	1-001TA-006	\$3.74	\$3.18	5/16"	4-1/2"	1-001TA-020	\$11.81	\$10.04
7/64"	2-5/8"	1-001TA-007	3.98	3.38	21/64"	4-5/8"	1-001TA-021	13.15	11.18
1/8"	2-3/4"	1-001TA-008	3.98	3.38	11/32"	4-3/4"	1-001TA-022	14.50	12.33
9/64"	2-7/8"	1-001TA-009	4.33	3.68	23/64"	4-7/8"	1-001TA-023	16.56	14.08
5/32"	3-1/8"	1-001TA-010	4.40	3.74	3/8"	5"	1-001TA-024	16.83	14.31
11/64"	3-1/4"	1-001TA-011	4.79	4.07	25/64"	5-1/8"	1-001TA-025	19.51	16.58
3/16"	3-1/2"	1-001TA-012	5.33	4.53	13/32"	5-1/4"	1-001TA-026	19.97	16.97
13/64"	3-5/8"	1-001TA-013	5.86	4.98	27/64"	5-3/8"	1-001TA-027	22.06	18.75
7/32"	3-3/4"	1-001TA-014	6.51	5.53	7/16"	5-1/2"	1-001TA-028	23.03	19.58
15/64"	3-7/8"	1-001TA-015	6.99	5.94	29/64"	5-5/8"	1-001TA-029	25.59	21.75
1/4"	4"	1-001TA-016	7.46	6.34	15/32"	5-3/4"	1-001TA-030	27.31	23.21
17/64"	4-1/8"	1-001TA-017	8.98	7.63	31/64"	5-7/8"	1-001TA-031	28.64	24.34
9/32"	4-1/4"	1-001TA-018	9.21	7.83	1/2"	6"	1-001TA-032	28.70	24.40
19/64"	4-3/8"	1-001TA-019	10.71	9.10					

29 Pc. Fractional Jobber Drill Set

118° POINT RIGHT HAND
HIGH SPEED STEEL



Jobbers length drills are designed to perform in a wide variety of normal conditions and in a broad range of materials in both machine and portable drilling.

1/16" - 1/2" by 64ths w/ Index
Part No. 1-001-0290
Reg. Net Price \$71.52

\$52⁹⁵

CUTTING TOOLS

KEO Long Series Combined Drills & Countersinks

60° INCLUDED ANGLE
HIGH SPEED STEEL

Used for producing center holes in components or workpieces with the extra length allowing access to difficult-to-reach areas.



Size	Body Dia.	Drill Dia.	OAL	Part No.	Reg. Net Price	SALE!
1	1/8"	3/64"	3"	1-047A-130	\$25.43	\$22.89
1	1/8"	3/64"	4"	1-047A-140	26.55	23.90
1	1/8"	3/64"	5"	1-047A-150	36.86	33.17
1	1/8"	3/64"	6"	1-047A-160	48.28	43.45
2	3/16"	5/64"	4"	1-047A-240	29.09	26.18
2	3/16"	5/64"	5"	1-047A-250	37.28	33.55
2	3/16"	5/64"	6"	1-047A-260	48.47	43.62
3	1/4"	7/64"	4"	1-047A-340	30.65	27.59
3	1/4"	7/64"	5"	1-047A-350	40.31	36.28
3	1/4"	7/64"	6"	1-047A-360	48.90	44.01
4	5/16"	1/8"	4"	1-047A-440	33.94	30.55
4	5/16"	1/8"	5"	1-047A-450	43.39	39.05
4	5/16"	1/8"	6"	1-047A-460	50.10	45.09
5	7/16"	3/16"	4"	1-047A-540	44.62	40.16
5	7/16"	3/16"	5"	1-047A-550	51.66	46.49
5	7/16"	3/16"	6"	1-047A-560	58.00	52.20
6	1/2"	7/32"	5"	1-047A-650	55.50	49.95
6	1/2"	7/32"	6"	1-047A-660	67.08	60.37

KEO 5 Pc. Combined Drill and Countersink Set

60° RIGHT HAND
HIGH SPEED STEEL



No. 1 through No. 5
Part No. 1-031-200
Reg. Net Price \$65.01
\$55.26



Plain type combined drills and countersinks are used for producing center holes in components or workpieces which require machining between centers.

Supplied with a plastic case.

Milwaukee 6 Pc. Annular Cutter Set

NEW!

With 20% thinner walls, these cutters displace less material for the same size hole, giving you fast, burr-free holes in anything from sheet metal to thick steel plate. Each cutter comes with a 3/4" Weldon shank, which is ideal for use with most small magnetic drill presses and large magnetic drill presses with the correct arbor.

Part No. **\$299.00**
1-828-4922840

FEATURES:

- 15% Faster cutting: Thinner wall construction displaces less material.
- Long Lasting: Proprietary steel with three hardness zones reduces breakage and extends bit life.
- Versatile Design: One retractable pilot pin works for all 1" sizes and another works for all 2" sizes
- Multipurpose 3/4" Weldon Shanks: Work with most magnetic drill presses and large magnetic presses with the right sized arbor.
- Dual Alternating Tooth Geometry: Double bevel and flat teeth cut more aggressively and boost chip ejection.



SET INCLUDES:

- (1 Each Size) Annular Cutter: 9/16", 5/8", 11/16", 13/16", 15/16"
- (1) 1-1/16" Annular Cutter.
- (1) Ejector Pin.
- (1) 1" Retractable Pilot Pins.
- Sturdy Carrying Case.

EZ COIL Thread Repair Kits

- KITS INCLUDE: • (1) Drill • (1) Installation Tool
• (10) Inserts • (1) Tap • (1) Tang Break

Thread Size	Part No.	Reg. Net Price	SALE!
4-40 x 1.5D	1-842-SK20215	\$55.30	\$47.01
5-40 x 1.5D	1-842-SK20315	55.30	47.01
6-32 x 1.5D	1-842-SK20415	52.14	44.32
8-32 x 1.5D	1-842-SK20515	53.95	45.86
10-24 x 1.5D	1-842-SK20615	49.31	41.91
12-24 x 1.5D	1-842-SK20715	60.52	51.44
1/4-20 x 1.5D	1-842-SK20815	54.83	46.61
5/16-18 x 1.5D	1-842-SK20915	59.62	50.68
3/8-16 x 1.5D	1-842-SK21015	70.96	60.32
4-48 x 1.5D	1-842-SK30215	55.30	47.01
6-40 x 1.5D	1-842-SK30415	52.14	44.32
8-36 x 1.5D	1-842-SK30515	53.95	45.86
10-32 x 1.5D	1-842-SK30615	49.31	41.91
1/4-28 x 1.5D	1-842-SK30815	53.06	45.10
5/16-24 x 1.5D	1-842-SK30915	61.95	52.66
3/8-24 x 1.5D	1-842-SK31015	70.96	60.32



MICRO 100 Style C Carbide Toolbits

Square Nose Tool

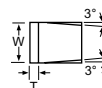

MICRO-GRAIN CARBIDE +PLUS!

MICRO 100 is a space age, micro-grain carbide of excellent quality. It is in a class of it's own, resulting from the exclusive treating process. Considerably prolongs tool life in machining all hard stainless steels, efficiently performs in exotic metals. Provides vastly increased speed and feed rates in cutting aluminum, copper, stainless steels, high temperature alloys, thermoplastics and composites used in the aircraft industry.

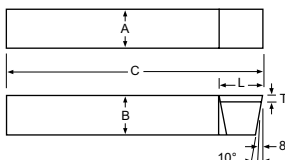

Dimensions						Part No.	Reg. Net Price	SALE!
Shank			Tip					
A	B	C	T	W	L			
1/4"	1/4"	2"	1/16"	1/4"	1/4"	1-428-C4	\$18.01	\$15.31
5/16"	5/16"	2-1/4"	3/32	5/16"	3/8"	1-428-C5	20.32	17.27
3/8"	3/8"	2-1/2"	3/32	3/8"	3/8"	1-428-C6	20.76	17.65
7/16"	7/16"	3"	3/32	7/16"	1/2"	1-428-C7	29.89	25.41
1/2"	1/2"	3-1/2"	1/8"	1/2"	1/2"	1-428-C8	25.71	21.85
5/8"	5/8"	4"	5/32	5/8"	5/8"	1-428-C10	44.52	37.84
3/4"	3/4"	4-1/2"	3/16"	3/4"	3/4"	1-428-C12	53.54	45.51

M.A. FORD 6 Flute Chatterless Countersinks & Sets

Series 79

For economical, general purpose countersinking, chamfering, or deburring.



SETS INCLUDE (1 Each): 1/4", 5/16", 3/8", 1/2", 5/8", 3/4", and 1" with a particular point angle in a plastic case.

Included Angle	Part No.	Reg. Net Price	NOW!
60°	5-100-79001	\$265.89	\$226.01
82°	5-100-79006	265.89	226.01
90°	5-100-79011	265.89	226.01
100°	5-100-79016	265.89	199.42



FEATURES:

- Steam homogenized surface treatment (blackening) to prolong tool life and prevent galling.
- Because of the multiple flute design, chip loads are generally smaller and even at maximum speeds, chatter-free machining is possible.

Stock Up To Save Big!
Up to 1/2" 3 Per Pack

INDIVIDUAL COUNTERSINKS

Body Dia.	OAL	Shank Dia.	60°			82°			90°		
			Part No.	Reg. Net Price	NOW!	Part No.	Reg. Net Price	NOW!	Part No.	Reg. Net Price	NOW!
1/4"	2"	1/4"	5-100-79071	\$17.57	\$14.93	5-100-79076	\$17.57	\$14.93	5-100-79081	\$17.57	\$14.93
5/16"	2"	1/4"	5-100-79096	20.96	17.82	5-100-79101	20.96	17.82	5-100-79106	20.96	17.82
3/8"	2"	1/4"	5-100-79121	21.75	18.49	5-100-79126	21.75	18.49	5-100-79131	21.75	18.49
1/2"	2"	3/8"	5-100-79146	26.85	22.82	5-100-79151	26.85	22.82	5-100-79156	26.85	22.82
5/8"	2-1/4"	3/8"	5-100-79171	38.77	32.95	5-100-79176	38.77	32.95	5-100-79181	38.77	32.95
3/4"	2-3/4"	1/2"	5-100-79196	53.15	45.18	5-100-79201	53.15	45.18	5-100-79206	53.15	45.18
7/8"	2-3/4"	1/2"	5-100-79221	72.95	62.01	5-100-79226	72.95	62.01	5-100-79231	72.95	62.01
1"	2-3/4"	1/2"	5-100-79246	81.23	69.05	5-100-79251	81.23	69.05	5-100-79256	81.23	69.05

DORIAN TOOL STVO R Indexable Toolholders STYLE V

- FEATURES:**
- O.D. threading and shallow grooving.
 - For use with triangular 60° V TNMC threading style inserts.



Tool Style	Shank Height A	Shank Width B	OAL C	E	F	G	Max. Groove Depth V	TNMC Insert Series	Part No.	Reg. Net Price	SALE!
STVOR/L 08-3A	1/2"	1/2"	4"	1.000"	5/8"	1/8"	.150"	322	1-285R-160	\$141.31	\$120.11
STVOR/L 10-3B	5/8"	5/8"	4-1/2"	1.000	3/4"	1/8"	.150		1-285R-161	148.34	126.09
STVOR/L 12-3B	3/4"	3/4"	4-1/2"	1.000	7/8"	1/8"	.150		1-285R-162	156.31	132.86
STVOR/L 16-3D	1	1	6	1.250	1-1/4"	1/4"	.150		1-285R-164	173.99	147.89
STVOR/L 12-4B	3/4"	3/4"	4-1/2"	1.250	7/8"	1/8"	.230	432	1-285R-163	163.41	138.90
STVOR/L 16-4D	1	1	6	1.250	1-1/4"	1/4"	.230		1-285R-165	173.99	147.89
STVOR/L 20-4D	1-1/4"	1-1/4"	6	1.250	1-1/2"	1/4"	.230		1-285R-166	200.46	170.39

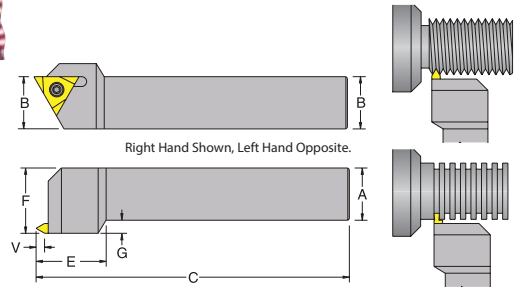

DORIAN TOOL MWLN R Indexable Toolholders STYLE L

- FEATURES:**
- Negative 5° end or side cutting edge angle.
 - For use with negative 80° trigon WNMG inserts.

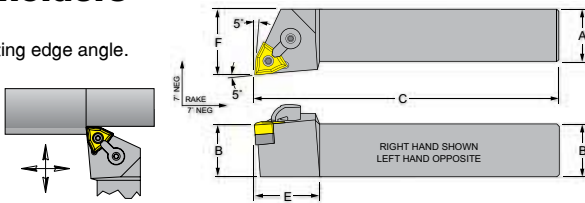

Tool Style	Shank Height A	Shank Width B	OAL C	E	F	WNMG Insert Series	Part No.	Reg. Net Price	SALE!
MWLN R 12-3B	3/4"	3/4"	4-1/2"	1"	1"	332	1-285R-129	\$146.25	\$131.63
MWLN R 12-4B	3/4"	3/4"	4-1/2"	1-1/4"	1"	432	1-285R-065	146.25	131.63
MWLN R 16-4D	1	1	6	1-1/4"	1-1/4"		1-285R-070	158.95	143.06

fmx "TURBO" Face Milling Cutters

RIGHT HAND CUT

- FEATURES:**
- Cutting Depth (a): 5/8".
 - 90° square shoulder cutter body.
 - APXT utility inserts make this an economical and multi-purpose choice.

TOOL ANGLES:
 Cutting Rake Angle -12° to -6°
 Radial Rake Angle -12° to -6°
 Axial Rake Angle 7° to 10°
 Setting Angle 90°



Dia.	Arbor Hole	Height	No. of Inserts	Part No.	Reg. Net Price	SALE!
1-1/2"	1/2"	1-37/64"	4	6-954-015	\$400.42	\$340.36
2	3/4"	1-37/64"	5	6-954-020	409.70	348.25
2-1/2	1	1-37/64"	6	6-954-025	502.46	427.09
3	1	1-31/32"	6	6-954-030	533.39	453.38
4	1-1/4"	1-31/32"	8	6-954-040	695.71	591.35
5	1-1/2"	2-31/64"	9	6-954-050	859.60	730.66

20% OFF Select KORLOY Coated Inserts

GRADE TG-320: Excellent coated grade for general purpose cuts in steel and steel alloys. Equivalent to P10-P30 grade. Recommended cutting speed 500-1,000 SFM.



KORLOY TCMT Carbide Inserts

- FEATURES:**
- Single sided.
 - 7° relief angle.
 - Screw on insert.
 - Standard chip control.
 - Use for medium cuts.
 - Depth of Cut: 3/64" ~ 1/8".
 - Feed Rate: .004" ~ .012"/rev."

TRIANGULAR



ASA Code	I.C.	Hole Dia.	Thick.	Corner Radius	Part No.	Reg. Net Price	SALE!
TCMT-21.51	1/4"	.110"	3/32"	1/64"	1-2443-927	\$13.98	\$11.18
TCMT-21.52	1/4"	.110	3/32	1/32	1-2443-928	13.98	11.18
TCMT-32.51	3/8"	.173	5/32	1/64	1-2443-929	16.81	13.45
TCMT-32.52	3/8"	.173	5/32	1/32	1-2443-930	16.81	13.45

KORLOY CCMT Carbide Inserts

80° DIAMOND

- FEATURES:**
- Single sided.
 - 7° relief angle.
 - Screw on insert.
 - Standard chip control.
 - Use for medium cuts.
 - Depth of Cut: 3/64" ~ 1/8".
 - Feed Rate: .004" ~ .012"/rev.



ASA Code	I.C.	Hole Dia.	Thick.	Corner Radius	Part No.	Reg. Net Price	SALE!
CCMT-21.51	1/4"	.110"	3/32"	1/64"	1-2443-931	\$15.66	\$12.53
CCMT-32.51	3/8"	.173	5/32	1/64	1-2443-932	16.08	12.86
CCMT-32.52	3/8"	.173	5/32	1/32	1-2443-933	16.08	12.86
CCMT-431	1/2"	.216	3/16	1/64	1-2443-934	21.32	17.06
CCMT-432	1/2"	.216	3/16	1/32	1-2443-923	21.32	17.06

KORLOY WNMG-GM Carbide Inserts

- FEATURES:**
- Double sided.
 - 0° relief angle.
 - GM chip control.
 - Pin and clamp insert.
 - Use for medium to light cuts.
- SPECIFICATIONS:**
- Thickness 3/16"
 Corner Radius 1/32"
 Depth of Cut028" ~ .157"
 Feed Rate004" ~ .020"/rev.



ASA Code	I.C.	Hole Dia.	Part No.	Reg. Net Price	NOW!
WNMG-332-GM	3/8"	.150"	1-2443-915	\$14.56	\$11.65
WNMG-432-GM	1/2"	.203	1-2443-921	17.31	13.85

80° TRIGON

Indexable Turning Tool Sets

FEATURES:

- Ready to use.
- No grinding.
- No tool resetting.
- Purchase the shank once, index the cutting edge from then on.
- Versatility of cutting in any direction.
- Uses TT Style (7° positive rake) inserts.
- Built-in chip breaker groove.
- Positive rake cutting action.
- Different radii available.

TOOL HOLDER SETS save time & money! Have the right style holder on hand.

SETS INCLUDE:
5 Tools in Styles – TAR, TAL, TBR, TBL, & TE.

Set No.	Shank Size	Part No.	Reg. Net Price	SALE!
ST-6	3/8"	1-254-200	\$148.23	\$96.35
ST-8	1/2"	1-254-205	156.67	101.84

DORIAN TOOL Indexable 2" Diameter Recyclable 15° Face Mill

- FEATURES:**
- Recycles negative inserts, 80° diamond.
 - Index insert with four cutting edges.
 - High rate of material removal.
 - Torx screw (TS-1032-5M1) locking system.
 - Number of Inserts: 3.
 - Insert: CNMG-432.
 - Torx Key: T-20.

After the cutting edges are used on your turning toolholder, do not throw the insert away. It can be used in this milling cutter to utilize two more cutting edges that were not used in your lathe work.

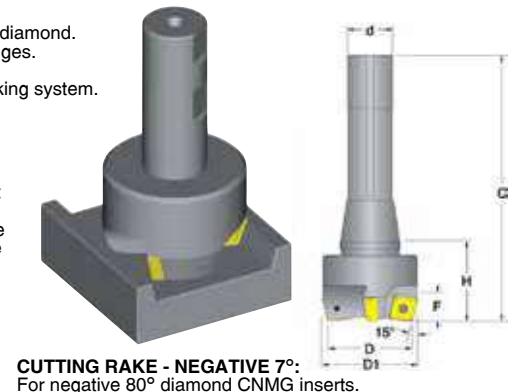
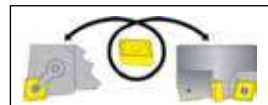

CUTTING RAKE - NEGATIVE 7°:
For negative 80° diamond CNMG inserts.

Tool Number	C	D	D1	d	F	H	Part No.	Reg. Net Price	NOW!
REC15-200-CN4-075	3-1/4"	2"	2-1/4"	3/4"	.45	1-1/2"	1-286A-080	\$394.11	\$334.99
REC15-200-CN4-100	4	2	2-1/4	1	.45	1-1/2"	1-286A-085	394.11	334.99
REC15-200-CN4-R8	5-5/8"	2	2-1/4	R8	.45	1-3/4"	1-286A-090	497.25	422.66

VERTEX Simple Indexing Spacers

NEW!

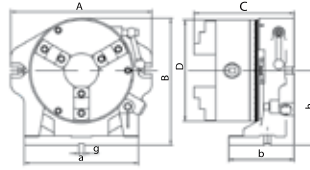

FEATURES:

- Big center through hole suitable for large and long workpieces.
- Rapid indexing and easy operation, excellent for mass production.
- Hardened and ground 24 position master plate, can index 15° with accuracy.
- Using the key guide block, the center can be corrected quickly and accurately.
- Includes 3-jaw chuck, masking plates 2, 3, 4, 6, 8, 12.

Chuck Dia.	A	B	C	D	a	b	h	g	Through Hole Dia.	Weight	Part No.	Reg. Net Price	SALE!
6"	9.96"	8.85"	7.04"	6.29"	7.36"	4.52"	5.11"	.62"	1.73"	65 lbs.	8-551-060	\$1,362.54	\$1,226.29
8"	12.51"	10.78"	8.22"	7.87"	9.05"	6.10"	6.18"	.62"	2.28"	113 lbs.	8-551-062	1,799.98	1,619.98

AMPG ACCURATE MANUFACTURED PRODUCTS GROUP QuickClamp

FEATURES:

- Clamps quickly and easily to the top of existing hard jaws or soft jaws.
- Attaches to any vise jaw (1/2"-1") with one screw adjustment.
- May be used in any position without modification to jaws.
- Very handy for small parts that do not require the full jaw length.



Part No. 1-850-QK1 **\$49³⁷**
Reg. Net Price \$58.08

TMX Live Centers with Interchangeable Inserts

7 Centers In 1

Set is provided with the main body and seven different style inserts in a wooden case. Body of the live center and inserts are made from forging, hardened and precisely ground. Special sealing ring protects the bearings from coolant and dust.



Morse Taper	Max. RPM	Max. Workpiece Wgt. (lbs.)	Part No.	Reg. Net Price	SALE!
2	5,000	220	7-570-002	\$762.19	\$647.86
3	4,000	440	7-570-003	878.15	746.43
4	3,000	880	7-570-004	1,161.07	986.91

6 Pc. Quick Change Tool Post Sets

All Toolholders Interchangeable with Aloris Type Toolholders.



Lathe Swing Up to 12"

SET INCLUDES:

- Piston Type Tool Post Series 100 (100).
- Turning & Facing Holder #1 (101).
- Boring, Turning & Face Holder #2 (102).
- Heavy-Duty Boring Bar Holder #4 (104).
- Universal Parting Blade Holder (107).
- Knurling, Turning & Facing Holder (110).

Part No. 1-459-500
Reg. Net Price \$585.43

\$497⁶²

Lathe Swing 10 to 15"

SET INCLUDES:

- Piston Type Tool Post Series 200 (200).
- Turning & Facing Holder #1 (201).
- Boring, Turning & Face Holder #2 (202).
- Heavy-Duty Boring Bar Holder #4 (204).
- Universal Parting Blade Holder (207).
- Knurling, Turning & Facing Holder (210).

Part No. 1-459-600
Reg. Net Price \$653.88

\$555⁸⁰



Three-Jaw Plain Back Self-Centering Scroll Chucks

SEMI-STEEL BODY

save 20%

These modern Bison precision lathe chucks can be used on all types of lathes and different kinds of milling, drilling and CNC attachments.

Body made of quality cast iron. All guideways and bearing surfaces are precisely machined. Scroll Plate drop forged of fine alloy steel, carefully case hardened. Thread flanks ground on both sides. Jaw teeth and guides are hardened and fully ground on both sides. Pinions hardened and ground.



WITH TWO-PIECE REVERSIBLE JAWS

Size	Thru-Hole Diameter	Weight (lbs.)	Part No.	Reg. Net Price	SALE!
5"	1.2598"	10	7-800-050	\$1,152.78	\$922.22
6	1.6535	19	7-800-060	1,226.13	980.90
8	2.1654	34	7-800-080	1,495.61	1,196.49
10	2.9922	57	7-800-100	2,010.61	1,608.49



CAT40 V-Flange End Mill Holders



Bore	Proj.	Dia.	Part No.	Reg. Net Price	SALE!
1/8"	2.37"	.69"	7-520-22907	\$156.59	\$133.10
3/16	2-1/2	.69	7-520-22909	156.59	133.10
1/4	3	.78	7-520-22911	156.59	133.10
3/8	3	1	7-520-22915	156.59	133.10
1/2	1-3/4	1-1/2	7-520-22917175	156.59	133.10
1/2	2-1/2	1-1/4	7-520-22917212	156.59	133.10
1/2	3	1-1/4	7-520-22917	156.59	133.10
1/2	4.63	1-3/4	7-520-22918	218.04	185.33
5/8	1-3/4	1-1/2	7-520-22919175	156.59	133.10
3/4	1-3/4	1-3/4	7-520-22921175	176.52	150.04
3/4	3	1-3/4	7-520-229213	156.59	133.10
1	1-3/4	2	7-520-22925175	176.52	150.04
1	4	2	7-520-22925	176.52	150.04
1-1/2	4-1/2	2-1/2	7-520-22929	220.65	187.55

- FEATURES:**
- Balanced to 15,000 RPM at G6.3.
 - High precision bore (H5) is best in industry.
 - Taper ground to AT3 for maximum spindle contact.
 - Individually inspected, tested and certified for accuracy.



ER Collets



- FEATURES:**
- Standard 0.0002" T.I.R.
 - Collapse Range: 0.039"
 - Inspected for quality and accuracy.

ER 16 COLLETS

Size	Part No.	Reg. Net Price	SALE!
1/16"	7-520-16004	\$53.93	\$45.84
1/8"	7-520-16008	40.76	34.65
3/16	7-520-16012	40.76	34.65
1/4	7-520-16016	40.76	34.65
5/16	7-520-16020	40.76	34.65
3/8	7-520-16024	40.76	34.65

ER 20 COLLETS

Size	Part No.	Reg. Net Price	SALE!
1/8"	7-520-20008	\$43.51	\$36.98
3/16	7-520-20012	43.51	36.98
1/4	7-520-20016	43.51	36.98
5/16	7-520-20020	43.51	36.98
3/8	7-520-20024	43.51	36.98
7/16	7-520-20028	43.51	36.98
1/2	7-520-20032	43.51	36.98

ER 25 COLLETS

Size	Part No.	Reg. Net Price	SALE!
1/8"	7-520-25008	\$46.03	\$39.13
3/16	7-520-25012	46.03	39.13
1/4	7-520-25016	46.03	39.13
5/16	7-520-25020	46.03	39.13
3/8	7-520-25024	46.03	39.13
7/16	7-520-25028	46.03	39.13
1/2	7-520-25032	46.03	39.13
9/16	7-520-25036	46.03	39.13
5/8	7-520-25040	46.03	39.13

ER 32 COLLETS

Size	Part No.	Reg. Net Price	SALE!
1/8"	7-520-32008	\$44.79	\$38.07
3/16	7-520-32012	44.79	38.07
1/4	7-520-32016	44.79	38.07
5/16	7-520-32020	44.79	38.07
3/8	7-520-32024	44.79	38.07
7/16	7-520-32028	44.79	38.07
1/2	7-520-32032	44.79	38.07
9/16	7-520-32036	44.79	38.07
5/8	7-520-32040	44.79	38.07



TECHNIKS CAT40 V-Flange Keyless Drill Chuck

1/2" Drill Chuck
Projection 4" / Diameter 2.5"

- FEATURES:**
- Powerful drawbar holds chuck tight.
 - Replaceable chuck is held by a drawbolt.
 - 3x more holding power than other chucks.
 - Holds non-standard shank sizes up to 1/2".



Part No. **7-520-22403**
Reg. Net Price \$418.53 **\$355⁷⁵**



ROHM Ball Bearing Key-Type Drill Chucks

High clamping power for heavy duty industrial use.

- FEATURES:**
- Vibration free.
 - Accurate and true.
 - Easy smooth jaw movement.
 - Body & key holes hardened.
 - Long life.
 - Jaws induction hardened.
 - Direct power-transmission - Gear & scroll combined in one.

Capacity	Taper Mount	Jacobs Key	Part No.	Reg. Net Price	SALE!
1/32 - 1/2"	3JT	K3	1-507-215000	\$473.59	\$426.23
1/32 - 5/8	3JT	K3	1-507-215001	636.31	\$572.68
3/16 - 3/4	4JT	K4	1-507-215002	799.04	\$719.14

MADE IN GERMANY



Boring Head & Carbide Tipped Boring Bar Sets With R8 Removable Shank

SET INCLUDES:

Shank Dia.	Min. Bore	Bore Depth
1/2"	5/16"	3/4"
	5/16"	1-1/8"
	5/16"	1-1/2"
	7/16"	1-1/8"
	7/16"	1-11/16"
	7/16"	2-1/4"
9/16"	9/16"	1-1/2"
	9/16"	2-1/4"
	9/16"	3"

9 Pc. C-6 Boring Bar Set
2" Dia. Boring Head (7/8"-20 Mount) with 9 Pc. C-6 Boring Bar Set
Part No. **1-800-922B**
Reg. Net Price \$257.52 **\$218⁸⁹**



12 Pc. C-6 Boring Bar Set
3" Dia. Boring Head (1-1/2"-18 Mount) with 12 Pc. C-6 Boring Bar Set
Part No. **1-800-923B**
Reg. Net Price \$419.49 **\$356⁵⁷**

SET INCLUDES:

Shank Dia.	Min. Bore	Bore Depth
3/4"	7/16"	1-1/4"
	7/16"	1-11/16"
	7/16"	2-1/4"
	9/16"	1-1/2"
	9/16"	2-1/4"
	9/16"	3"
	11/16"	1-7/8"
	11/16"	2-13/16"
	11/16"	3-3/4"
	13/16"	2-1/4"
	13/16"	3-3/8"
	13/16"	4-1/2"



EDGE TECHNOLOGY Chuck Stop Set

Designed to locate shorter parts beyond the chuck jaws to provide clearance for facing operations.

- FEATURES:**
- The chuck stop includes 10 sets of different height parallel bars to achieve the required spacing. Parallel bar heights from 1/2" to 1-5/8" in 1/8" increments. 0.0002" parallelism accuracy.
 - A centering plug is used to keep the unit centered to the ID of the chuck and strong neodymium magnets secure it to the face of the chuck. The included centering plug diameters are 1.4", 2", 2-1/2", 3", 3-1/2", & 4".
 - The chuck stop is 6" in diameter. For use on 6" diameter chucks and larger. Supplied in a case.



Part No. **1-811-30000**
Reg. Net Price \$325.46 **\$276⁶⁴**

2-3/8" Toolmakers Precision Steel Vise

Made from hardened alloy steel.

- FEATURES:**
- Single piece construction with V-grooved jaws.
 - All surface including jaws and base are precision ground square and parallel.
 - Clamping slots at bottom easily affix to angle plates, etc.

SPECIFICATIONS:

Jaw Width 2-3/8"
Jaw Depth 1"
Max. Jaw Opening 2-1/8"
Body Length 4-3/8"
Weight 3.3 lbs.

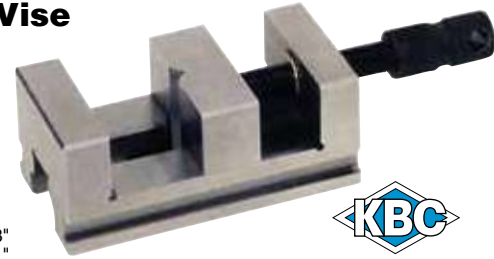

Part No. **2-466-000**
Reg. Net Price \$142.89 **\$121⁴⁶**

KURT WORKHOLDING DX6™ Crossover™ Vise

- FEATURES:**
- DX6™ CrossOver™ vise is a combination of AngLock®, Pull-Type, and 4 bolt stationary jaw design.
 - AngLock® design reduces stress on body during clamping.
 - Pull-type design reduces stress on body during clamping.
 - 4 bolt design reduces stationary jaw deflection & alleviates body stress.
 - Bed height matched to size 2.875" (73.025mm) ±.0005".
 - 80,000 PSI ductile iron body, nut, and movable jaw.
 - Repeatability within .001".
 - Chip evacuation straight through the body.
 - GrooveLock jaw plate & workstop included.
 - Fits on D50-4-SA swivel base.
 - Hardened vise bed/jaw plates.
 - Includes handle.



Model No. DX6
Part No. **1-5721-DX6**
Reg. Net Price \$1,257.05

\$1,068⁴⁹



SPECIFICATIONS:

Jaw Width 6"
Max. Jaw Opening 9.08"
Jaw Depth 1.735"
Vise Length 16.810"
Vise Width 7.391"
Max. Clamping Force 7,342 lbs.
Weight 65 lbs.

PALMGREN Low Profile Drill Press Vises

- FEATURES:**
- Replaceable jaws.
 - DPL60 smooth jaw.
 - DPL40 movable jaw and a vertical horizontal V-groove.
 - Base has four 1/2" shoulder slots for quick, easy positioning on drill press tables.



Model DPL40

Model No.	Jaw Width	Jaw Depth	Jaw Opening	Height	Weight (lbs.)	Part No.	Reg. Net Price	SALE!
DPL40	4"	1-1/2"	4"	2-7/8"	15	1-549-DPL40	\$235.97	\$200.57
DPL60	6"	2"	6"	3-9/16"	34	1-549-DPL60	436.14	\$370.72

TMX 6" Milling Machine Vise

NEW!

For all your CNC milling machine needs whether heavy milling, tapping, drilling, or grinding. TMX vises deliver the same proven accuracy every time. Improving on industry standards; ultra precision in flatness, parallelism and vertically.

- FEATURES:**
- Chip cover for lead screw protection.
 - Close tolerance bed heights for excellent accuracy.
 - Sealed bearing system increases the life of the vise.
 - Anti-lift mechanism keeps the work piece from lifting.
 - Body made from high quality ductile iron hardened to 45 RC.

SPECIFICATIONS:

Jaw Opening 8.9"
Jaw Depth 2.05"
Jaw Width 5.98"
Vise Dimensions ... 17.2" x 8.75" x 4.63"



10 Year Warranty!
Part No. **3-220-0068**
Reg. Net Price \$1,179.62 **\$1,002⁶⁸**

SUPERIOR 2" SHUR-KUT® Quick Change Discs

PREMIUM ALUMINUM OXIDE

Equal to Lockit®, PowerLock III®, & Roloc TR® TYPE "R"

FEATURES:

- Mold and cavity grinding.
- General purpose grinding aid and aggressive stock removal.
- Max. Speed: 25,000 RPM
- Deburring, edge breaking, surface leveling.



Grit	Part No.	ONLY! Price/Disc	SALE! Price Ea. 100 Pack
36	1-613-11214	\$1.27	\$1.14
60	1-613-11217	1.14	1.03
80	1-613-11218	1.12	1.01
120	1-613-11220	1.09	.98

Grits 36-60: Weld removal.
Grits 80-120: Blending of pits, gouges, & surface imperfections.

PFERD Mini-Grinder Brushes



Maximize your "Mini" grinder with the line of compact brushes. Designed specifically to fit the majority of the mini-grinders used today, our wide line and multiple arbor hole adaptation covers both light and heavy-duty cleaning jobs. Carbon steel wire.



Knot Style Cup Wheel
Wheel Dia.: 2-3/4"
Trim Length: 7/8"

Part No. 1-621-115 **\$37⁶⁵**
Reg. Net Price \$44.29

5/8"-11
THREADED HOLE
WIRE SIZE .020"



Stringer Bead Twist Wheel
Wheel Dia.: 4"
Trim Length: 3/4"
Face Width: 3/16"

Part No. 1-621-117 **\$35³⁵**
Reg. Net Price \$41.59



ACROlaps 6 Pc. Barrel Laps & Set

For Lapping, Polishing, and Deburring.

Barrel Laps insure fast, accurate lapping of long or short holes. Instantly, accurately adjustable.

FEATURES:

- Milled eccentric slot in brass barrel permit expansion of up to 15% or more by simply turning adjusting screw.
- Easy does it. No set-up time. No special equipment needed.
- Longer life built into each ACROlap greatly reduces your lapping costs.
- Supplied with a hardwood base.

3/16" to 1/2" by 16ths
Part No. 1-644B-200
Reg. Net Price \$184.15

\$138¹¹

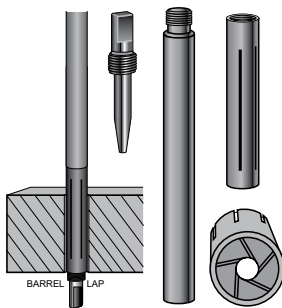

OVERSTOCK SALE!
Quantities Limited.



CRATEX Rubberized Abrasive Kit

KIT INCLUDES:

- (2) Point Mandrels No.4 (1/8" shank)
- (2) Point Mandrels No.6 (1/8" shank)
- (8) Bullet Points No.8 (1" length x 9/32" dia.)
- (8) Bullet Points No.10 (5/8" length x 3/8" dia.)
- (8) Bullet Points No.11 (1" length x 3/8" dia.)
- (8) Cylinder Points No.4 (1/2" length x 1/4" dia.)
- (8) Cylinder Points No.6 (7/8" length x 1/4" dia.)
- (8) Tapered Points No.12 (7/8" lg x 3/8"-5/16" dia.)
- (8) Tapered Points No.14 (7/8" lg x 5/8"-1/8 dia.)
- (8) Bullet Points No.15 (7/8" length x 1/2" dia.)



Equally assorted in the 4
Cratex Grit Textures - C, M, F, & XF

Part No. 1-614-778 **\$216⁹⁵**
Reg. Net Price \$271.19

Diamond Flaring Cup Wheel Type 11V9

FEATURES:

- Resin bonded.
- 150 Grit, 100 Concentration - 1/8" Depth
75 Concentration - 1/16" Depth
- For tool and cutter applications including sharpening of end mills, reamers, milling cutters and broaches.

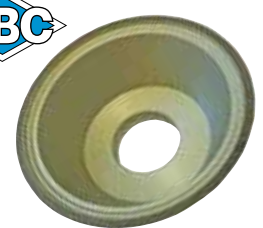
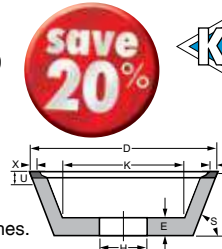

Maximize your "Mini" grinder with the line of compact brushes. Designed specifically to fit the majority of the mini-grinders used today, our wide line and multiple arbor hole adaptation covers both light and heavy-duty cleaning jobs. Carbon steel wire.



Knot Style Cup Wheel
Wheel Dia.: 2-3/4"
Trim Length: 7/8"

Part No. 1-621-115 **\$37⁶⁵**
Reg. Net Price \$44.29

5/8"-11
THREADED HOLE
WIRE SIZE .020"



Stringer Bead Twist Wheel
Wheel Dia.: 4"
Trim Length: 3/4"
Face Width: 3/16"

Part No. 1-621-117 **\$35³⁵**
Reg. Net Price \$41.59



ACROlaps 6 Pc. Barrel Laps & Set

For Lapping, Polishing, and Deburring.

Barrel Laps insure fast, accurate lapping of long or short holes. Instantly, accurately adjustable.

FEATURES:

- Milled eccentric slot in brass barrel permit expansion of up to 15% or more by simply turning adjusting screw.
- Easy does it. No set-up time. No special equipment needed.
- Longer life built into each ACROlap greatly reduces your lapping costs.
- Supplied with a hardwood base.

3/16" to 1/2" by 16ths
Part No. 1-644B-200
Reg. Net Price \$184.15

\$138¹¹

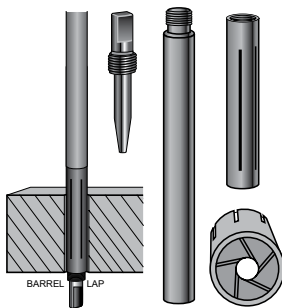

OVERSTOCK SALE!
Quantities Limited.



CGW ABRASIVES 3-in-1 Wheels .094 Cut/Grind/Finish Aluminum Oxide

FEATURES:

- High performance wheels made to cut quickly, grind easily, and finish work surfaces with ONE wheel.
- Contaminant free wheel has less than 0.1% iron, sulfur, or chlorine for rust-free and corrosion-free results.
- Cost effective wheel eliminates frequent wheel changes and increases production times.
- Three layers of fiberglass net reinforcement provides added strength and flexibility.
- For stainless steel and steel.

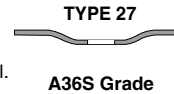

Size	Max RPM	Part No.	ONLY!
4-1/2" x 3/32" x 7/8"	13,300	1-602-45218	\$4.40
5 x 3/32 x 7/8	12,250	1-602-45220	5.45
7 x 1/8 x 7/8	8,600	1-602-45234	7.44

CGW ABRASIVES Bench & Pedestal Grinding Wheels

Size	Grit	Max. RPM	Part No.	Reg. Net Price	SALE!
6" x 3/4" x H	36-M	4,456	1-595-38007	\$28.20	\$23.97
	46-M		1-595-38008	32.06	27.25
	60-M		1-595-38009	28.20	23.97
	80-M		1-595-38010	45.76	38.90
6 x 1 x H	36-O	4,456	1-595-38012	48.22	40.99
	46-M		1-595-38013	48.22	40.99
	60-M		1-595-38014	48.22	40.99
	80-M		1-595-38015	48.22	40.99
7 x 1 x H	36-M	3,760	1-595-38017	40.46	34.39
	46-M		1-595-38018	38.52	32.74
	60-M		1-595-38019	38.52	32.74
	80-M		1-595-38020	58.96	50.12
8 x 1 x H ⁴	36-O	3,600	1-595-38022	48.97	41.62
	46-M		1-595-38023	48.97	41.62
	60-M		1-595-38024	55.74	47.38
	80-M		1-595-38025	48.97	41.62

BROWN ALUMINUM OXIDE

General purpose off-hand work.



DESMOND®

Glide™ Dresser

FEATURES:

- Two angles provide fit on most grinders.
- For bench grinders without a permanent fixture.
- Adjustable 1/2 carat diamond nib glides across the tool rest.

Part No. 1-607-030 **\$128⁸⁶**
Reg. Net Price \$151.60

Replacement Diamond
Part No. 1-607-031
Reg. Net Price \$87.88



3M Scotch-Brite™ Roloc™ Disc Intro Pack

SPECIAL BUY!
Quantities Limited.

save 25%

PACK INCLUDES:

- 2" Scotch-Brite™ Roloc™ SC Surface Conditioning Discs (2 Ea. - Grades: very fine, medium, coarse)
- 3" Scotch-Brite™ Roloc™ SC Surface Conditioning Discs (2 Ea. - Grades: very fine, medium, coarse)
- 2" Scotch-Brite™ Roloc™ Light Grinding and Blending Disc (2 Ea. - Grade: super duty coarse)
- 3" Scotch-Brite™ Roloc™ Light Grinding and Blending Disc (2 Ea. - Grade: super duty coarse)
- (1) 3M™ Roloc™ Disc Pads 2" & 3" (hard)
- (2) 3M™ Roloc™ Shanks

Sizes 2" & 3"

Part No. **1-630-18254** **\$145²²**
Reg. Net Price \$193.63



TRIUMPH PLUS Z3 Flap Discs

FEATURES:

- Gives up to 30x more life than a resin fiber-disc.
- Cuts much cooler and reduces glazing and loading with self sharpening flaps.
- Especially lightweight design reduces operator fatigue and noise levels.

Z3 ZIRCONIA: Premium 100% Zirconia Aluminum with cotton backing to provide flexibility. Offers maximum cutting capacity, strong edge stability and long-life.

Size	Grit	Part No.	Reg. Net Price/Ea.	SALE!
4-1/2" x 7/8" 13,300 RPM	40	1-704-2302	\$8.38	\$7.54
	60	1-704-2304	8.38	7.54
	80	1-704-2305	8.38	7.54

TYPE 27 - Used when working on flat grinding surfaces. Most efficient when used between 0-15° angle.



SUPERIOR SHUR-KUT® Shop Rolls

1" x 50 Yards

FLEXIBLE "J" WT. RESIN CLOTH - A/O

For use on ferrous, non-ferrous, stainless, plastics, rubber, & composites.

FEATURES:

- Standard tool for maintenance departments, machine shops.
- Easily used for hand applications.
- Flexible material, fast cutting action.
- Use what you need to reduce waste.
- Ideal for lathe work when sanding to precise size.

OVERSTOCK SALE!
Quantities Limited.

save 30%



Grit	Part No.	Reg. Net Price	NOW!
80	1-613-12108	\$66.98	\$46.89
150	1-613-12111	64.82	45.37



All-Purpose Lubricant Abrasive Belt Grease Stick

FEATURES:

- Universal in use.
- No "loading" or "glazing".
- Light-bodied grease that spreads out thinly and remains "wet" on the belt and provides lubrication by penetrating the coated abrasive surface.
- For all belt polishing operations on metal, plastic, and glass.
- Prevents clogging and leaves the abrasive grit free to cut clean and smooth.



No. F-26
2-1/2" x 8" Tube
Part No. **1-442-F26**
Reg. Net Price \$22.08
\$18⁷⁷



A3 - Aluminum Oxide:

- Durable grain on X-Weight backing, closed coat for rapid stock removal and long life.
- For ferrous metals, stainless steel, non-ferrous metals, composites, plastics, and wood.



CGW ABRASIVES Portable, Benchstand & Backstand Belts

A3 - Aluminum Oxide

Size	Grit	Box Qty.	Part No.	Reg. Net Price	SALE!
1" x 42"	60	10	1-595-61092	\$3.39	\$3.05
	80	10	1-595-61093	3.31	2.98
	100	10	1-595-61094	3.20	2.88
2" x 48"	60	10	1-595-61120	5.79	5.21
	80	10	1-595-61121	5.47	4.92
	100	10	1-595-61122	5.21	4.69
6" x 48"	60	10	1-595-61294	15.87	14.28
	80	10	1-595-61295	15.13	13.62
	100	10	1-595-61296	14.36	12.92

SUPERIOR Cartridge Roll Assortment Kit

PREMIUM A/O "X" WT. RESIN BOND CLOTH



FEATURES:

- 120 pieces of the most popular sizes of straight tapered rolls from 1/4" to 1/2" diameter in both 1" and 1-1/2" lengths.
- Grits are 80 and 120 resin bond.
- (2) Mandrels with 1/4" shank.

Part No. **1-613-28802**
Reg. Net Price \$146.50
\$124⁵³

NORTON General Purpose Hand Pads

FEATURES:

- Surface finishing hand pads are made of a non-woven nylon web impregnated with abrasive grain and resin bond.
- Flexible: Conform to work surface.
- Gentle action easily removes flashing or burrs without affecting dimension of workpiece.
- Non-loading: Constant supply of new cutting edges.
- Non-rusting: No workpiece contamination.
- Resilient construction: long life, increased productivity, solvent resistant, waterproof.

6" x 9" MAROON ALUMINUM OXIDE

Box Qty.	Case Qty.	Part No.	ONLY!		
			Each	Ea./Box	Ea./Case
20	60	1-632-74700	\$1.63	\$1.47	\$1.14

CRESCENT NICHOLSON® 6 Pc. 4" American Pattern File Set

save 20%

Six of the most popular 4" files packaged in a plastic pouch.



SET INCLUDES (1 EACH):

- Warding File
- Half-Round File
- Round File
- Hand File
- Square File
- Slim-Taper

Part No. **1-552-22062** **\$94⁸²**
Reg. Net Price \$118.53

BASTARD CUT

5 Pc. Diamond Needle File Set

5-3/4" Overall Length
2-3/4" Diamond Section

SET INCLUDES (1 EACH):

- Equaling File
- Half Round File
- Round File
- Square File
- Three Square File

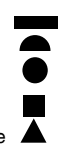

Medium Grit
Part No. **1-640-005**
Reg. Net Price \$34.05
\$28⁹⁴



iGAGING Heavy Duty Dial Calipers

NEW!

save 20%



FEATURES:

- 4-way measurement: outside, inside, step and depth.
- Hardened stainless steel frame and covered rack.
- Slide lock holds reading in place.
- Shock proof.
- Long jaws make hard-to-reach workpieces easier to access and measure.
- Dial Color: 12" White. 18" & 24" Black.
- Supplied in a protective case.

SPECIFICATIONS:

Reading 0.100"
Graduation 0.001"

Range	Jaw Depth	Accuracy	Part No.	Reg. Net Price	SALE!
0-12"	2.875"	±0.002"	1-815-112	\$251.53	\$201.22
0-18"	3.125"	±0.003"	1-815-118	284.92	211.94
0-24"	3.375"	±0.003"	1-815-124	324.12	259.30

iGAGING 11 Pc. Caliper Accessory Kit

FEATURES:

- Universal fit for all common 4", 6", 8", 12" regular vernier, dial, and electronic digital calipers.
- Measures slots, grooves, shoulders, holes, webs, and hard to reach areas.
- Corrosion protected coating.
- Anodized for corrosion resistance.
- #4-48 thread.

KIT INCLUDES:

- (3) Contacts.
- (1) Long Reach Arm.
- (2) Caliper Bodies.
- (1 Ea.) Ball, Cone, Flat, & Stem Points.
- (1) Allen Wrench.

NEW!



CALIPER NOT INCLUDED

Model No. 100-K400

Part No. 1-815-045 **\$3761**
Reg. Net Price \$44.25

iGAGING IP54 Absolute Origin Digital Indicators

With SPC/USB Data Output

save 20%

FEATURES:

- IP54 Protective Rating: Moisture and dust resistance.
- Absolute Encoding Technology: Memorize absolute origin zero.
- Ultra-Response measure speed.
- Inch/Metric conversion.
- High contrast LCD display.
- 330° display rotation.
- Preset and tolerance function.
- Ceramic contact point.
- Lug and flat back included.
- Battery 3V CR2032 included.
- Attachable finger lever included.

NEW!



SPECIFICATIONS:

Resolution 0.0005" (0.01mm)
Repeatability 0.0005"
Thread Size #4-48
Stem Diameter 3/8"

Range	Accuracy	Part No.	Reg. Net Price	SALE!
0-1/2" (0-12.7mm)*	0.0005"/0.01mm	1-815-430	\$133.13	\$106.50
0-1" (0-25.4mm)	0.0005"/0.01mm	1-815-432	162.73	130.18
0-2" (0-50.8mm)	0.001"/0.015mm	1-815-434	251.53	201.22

Supplied in a protective case.

* Attachable finger lever not included.

Thread Detective® Thread Identifier

Standard Combination Unit

Precise & easy-to-use for nuts & bolts.

FEATURES:

- Distinguish inch & metric threads.
- 6-32 to 1/2"-20 inch and M4x0.7 to M12x1.75 metric steel identifiers on a wire lanyard.
- Shatterproof, color coded gauge dividers.
- Easy-to-read size markings laser etched on each stand off.

Part No. 1-842-405
Reg. Net Price \$74.05
\$62⁹⁴

NEW!



Starrett® Dial Calipers

Series 3202

save over 20%

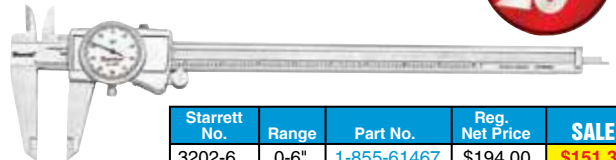

Starrett No.	Range	Part No.	Reg. Net Price	SALE!
3202-6	0-6"	1-855-61467	\$194.00	\$151.32
3202-12	0-12"	1-855-61466	403.00	314.34

FEATURES:

- Knife-edge contacts.
- Provides quick, accurate measurement of O.D., I.D., & depth.
- Thumb-operated fine adjustment roll.
- Hardened stainless steel bar, measuring surfaces, rack, gears and depth rod.
- Sharp, clear dial graduations.
- Lock screws for sliding jaw and adjustable dial bezel.
- Positive, spring-loaded double pinion anti-backlash control.

Mitutoyo ABSOLUTE Digimatic Calipers

Series 500 with Exclusive ABSOLUTE Encoder Technology



save up to 20%

Mitutoyo's Digimatic Caliper keeps track of its origin point once set. Whenever turned on, the large LCD screen displays the actual slider position ready to start measurement. No more repeated zero setting is necessary with the absolute encoder technology as well as no more care for overspeed errors.

FEATURES:

- Thumb roller included.
- Large and clear LCD readout.
- The ZERO/ABS key allows the display to be Zero-Set at any slider position along the scale for incremental comparison measurements. This switch will also allow return to the absolute (ABS) coordinate and display of the true position from the origin point (usually jaws-closed point).

NO SPC OUTPUT

Supplied in a fitted plastic case.

Range	Resolution	Part No.	Reg. Net Price	SALE!
0-6" (0-150mm)	.0005" (.01mm)	1-808-500196	\$221.00	\$176.80
0-8" (0-200mm)	.0005" (.01mm)	1-808-500197	319.00	271.15
0-12 (0-300mm)	.0005" (.01mm)	1-808-500193	636.00	540.60

IP54 Large Display Electronic Caliper



1 Year Warranty!



FEATURES:

- Precision lapped finish for smooth travel.
- IP54: Splash water, oil, and dust resistant.
- Resolution: .0005" (.01mm / 1/128" fractional).
- Hardened stainless steel body.

INCH - METRIC - FRACTIONAL

Range: 0-6" (0-150mm)
Part No. 1-815-100
Reg. Net Price \$86.19

\$59⁹⁵

Toolmaker's V-Blocks

2 Blocks & 2 Clamps



save 20%

A precision-made set for toolmakers and machinists. Made of hardened tool steel, machined and ground to close tolerances.

Clamping Capacity: 1" diameter.

1-1/4" Sq. x 1-5/8" Long

Part No. 1-805-117

Reg. Net Price \$57.30

\$45⁸⁴



Mitutoyo Depth Micrometer

With 6 Interchangeable Rods

Series 129

FEATURES:

- Satin-chromed finished throughout.
- Crisp, clear graduations on the thimble.
- Ratchet stop.

.157" diameter interchangeable rods, with lapped measuring end, are calibrated and tested at the factory. Rods are adjustable length, to compensate wear on the measuring tip, with 2 supplied wrenches.



Supplied with a fitted case.

Part No. **1-808-129132**
Reg. Net Price \$341.00
\$289⁸⁵

SPECIFICATIONS:

Range	0-6"
Rod Diameter157"
Base Length	2.5"
Graduation001"

iGAGING 0-22" Dial Depth Gage

With 6 Interchangeable Rods

Measure depths in tight spots and up to 22" deep with this super versatile tool. Instrument used to determine the depth of any shape that has a step, groove, or slot.

NEW!

save 20%



FEATURES:

- Super high precision dial indicator with twice the accuracy of regular indicators.
- Indicator gauge conforms to AGD standard and Federal Accuracy specifications.
- Indicator can be mounted on center or side of base.
- Includes 10 Attachments: (6) Extension Rods & (4) Feeler Points.
- Supplied with a protective case.

SPECIFICATIONS:

Range	0-22"
Rod Size	1-6"
Base Size	4"
Graduation	0.0005"

Black Face
Part No. **1-815-160**
Reg. Net Price \$97.57 **\$78⁰⁶**

6 Pc. Set-Up & Inspection Kits

OVERSTOCK SALE!
Quantities Limited.



INCLUDES:

- Dial Caliper: 0-6"
- 12" Blade 4R (8ths, 16ths, 32nds, 64ths).
- Outside Micrometer: 0-1" x .0001".
- Square, Protractor and Center Head.
- Fitted Plastic Case.

White Face Dial Caliper Kit
Part No. **8-135-0018**
Reg. Net Price \$194.89
\$139⁴⁵



Black Face Dial Caliper Kit
Part No. **8-135-0019**
Reg. Net Price \$194.89
\$139⁴⁵

0-1" Dial Indicator

FEATURES:

- White face with lug back.
- 4-48 thread.
- Revolution counter.
- .100 per revolution.

SPECIFICATIONS:

Graduation001"
Dial Reading	0-100
Dial Diameter	2-1/4"
Thread Size	#4-48
Stem Diameter	3/8"



SATISFACTION GUARANTEED!

save 20%

Part No. **8-100-001**
Reg. Net Price \$33.71 **\$26⁹⁷**



Starrett 0-1" Outside Micrometer

With Ratchet Thimble - Series 436

FEATURES:

- Rugged spindles, and anvils sized at .270" diameter.
- Smooth friction thimble for uniform pressure, the combination ratchet and speeder for uniform pressure and quicker adjustment.
- Satin chrome finish, no glare, and resists rust.
- Ring-type knurled lock nut for quick and sure locking.
- Micro-lapped measuring faces.
- Advanced sleeve design with staggered lines and distinct figures for precise and easy readability.
- Convenient decimal equivalents on one-inch micrometers.



.0001" GRADUATIONS
CARBIDE FACE

Supplied in a fitted case.

Starrett No. T436.1XRL-1
Part No. **1-855-67997**
Reg. Net Price \$246.00 **\$209¹⁰**

Mitutoyo 0-1" Coolant Proof Digimatic Micrometer

Ratchet Thimble

Series 293

FEATURES:

- Resolution: .00005" (.001mm).
- Measurement data output function is available with a water-resistant connection cable.
- Auto power ON/OFF function.
- Certificate of inspection is included. It is not the type used to obtain calibration certificates.
- IP65 protection level, enabling use in environments exposed to cutting oil, etc. Anti-corrosion treatment is required after use.



IP65

Supplied in a fitted plastic case.

NO SPC OUTPUT

Range: 0-1" (0-25mm)
Part No. **1-808-293344**
Reg. Net Price \$268.00 **\$227⁸⁰**

Inside Micrometers

With Standard

Provides accurate small internal measurements.

Part No. 1-812-215 Shown



save 20%



Supplied with a fitted case.

FEATURES:

- Chrome-plated.
- Caliper type jaws.
- Carbide measuring faces.
- Ratchet stop for exact repetitive readings.
- Graduation: .001".

Range	Setting Ring	Part No.	Reg Net Price	SALE!
0.2-1.2"	0.2"	1-812-215	\$102.23	\$81.78
1-2"	1.0	1-812-220	115.88	\$92.70

Fowler Dial Bore Gage Set

HIGH PRECISION

FEATURES:

- Depth: 9.5"
- Easy-to-read.
- Insulated grip.
- Self centering.
- Carbide anvils.
- Easily adjustable.
- Chrome plated handle.
- Graduation: .0005"

save 20%

Includes 2" extension holder and a fitted case.

Range: 2-6"
Part No. **52-646-300**
Reg. Net Price \$272.91
\$218³³



Interapid Horizontal Dial Test Indicator

SPECIFICATIONS:

Graduation0005"
Capacity060"
Dial Diameter	1-1/2"
Dial Reading	0-15-0
Carbide Point Diameter080"
Point Length	11/16"

5/32" Adapter Shank Diameter.

Model No. 312b-1
Part No. **1-818-004**
Reg. Net Price \$534.04 **\$453⁹³**



SWISS MADE

Supplied with a case.



save 25%

Precision Thin Parallel Set



FEATURES:

- 10 matched pairs 6" long by 1/8" wide: 1/2", 5/8", 3/4", 7/8", 1", 1-1/8", 1-1/4", 1-3/8", 1-1/2", 1-5/8".
- Accuracy .0002" parallelism in height, .001" to size in height.
- Made of high grade alloy steel, hardened and ground, two holes in each parallel.

Supplied in a plastic case.

Part No. **1-812-016** **\$100⁷³**
Reg. Net Price \$134.31

Magnetic Digital Angle Protractor

FEATURES:

- Large LCD display.
- Reversible reading.
- 3-side magnets (bottom & 2 side walls).
- Precision digital level sensor.
- Hold and ZERO functions.
- (1) 9V Battery Included.
- 1 Year Warranty.



save 20%

NEW!



SPECIFICATIONS:

Measuring Range 360° (4 x 90°)
Resolution05°
Accuracy ±.2°
Repeatability1°
Dimensions 2.2" x 2.2" x 1.2"

Part No. **1-815-200** **\$67³⁰**
Reg. Net Price \$84.12

4 Pc. Edge Finder Set



Head Type	Shank	Tip Dia.
Single	1/2"	.5000"
Double	1/2"	.5000/ .2000"
Single	3/8"	.2000"
Combo*	1/2"	.2000"

* Has a double head, with an edge finder on one end and a center finder on the other.

save 20%

Part No. **1-397-265**

Reg. Net Price **\$46.87** **\$37⁵⁰**



IP66 Digital Tool Setting Gage

FEATURES:

- IP66 Protective Reading.
- Alert back light will light-up when setting to zero.
- 5 strong magnets on base.
- Uses CR2032 replacement battery.

SPECIFICATIONS:

Range 1/2"
Resolution00005" (.001mm)
Accuracy ±.0015"
Repeatability ±.0001"

Supplied in a strong protective case.

Part No. **1-815-215** **\$117³³**
Reg. Net Price \$146.66



save 20%

NEW!



Replacement Battery
3-Volt Type CR2032
Part No. **1-541-358**
Reg. Net Price **\$5.04**

Wiggler & Center Finder

Wiggler and center finder with the snap-in snap-out ball socket. Used for accurately locating spindle centers, work points on drill presses, milling and other machines.

SET INCLUDES:

- Needle point.
- Ball Point.
- Disc Point.
- Indicator Holder.
- Chuck.

Supplied in a snap-button vinyl case.

Part No. **1-397-389** **\$15⁹⁴**
Reg. Net Price \$19.92



save 20%

10X LED Measuring Magnifier Loupe

FEATURES:

- Adjustable focus.
- 7 powerful LED lights with an on/off switch.
- Distortion free with fine resolution.
- Super high precision laser etched angle and length glass scales.
- (1) "AG9" Battery included.

SPECIFICATIONS:

Viewing Area 1-1/4"
Reticle Diameter..... 34mm

Part No. **1-815-610** **\$85⁵⁸**
Reg. Net Price \$106.97

Supplied with a protective padded leather case.



save 20%



Mitutoyo Absolute Digimatic Height Gages

Series 570 With Output

The height gage provides highly accurate height measurements with durability, excellent functionality and cost performance. Measurements are shown on a large, easy-to-read LCD display.

FEATURES:

- The built-in ABSOLUTE linear encoder eliminates the need for setting the reference point at every power on, making accurate measurements quick and easy.
- The hand-operated slider with fine adjustment carriage makes movements smooth and measurements precise.
- SPC output function for quick and easy data management in real time. Compatible with U-WAVE for wireless transmission of measurement data.
- Display features large LCD characters (11mm in height) for easier measurement reading and reduced eye strain.
- Large function buttons on display are positioned for easy operation.
- Durable, rigid construction ensures repeatable measurements over a longer lifespan.
- Functions: On/Off, Origin, Zero/ABS, Hold/Data, Inch/mm conversion.
- Alarm: Low voltage, counting value composition error.
- Includes a carbide-tipped long scribe, which is highly durable and creates accurate marks on your workpiece.



NEW!

Range	Resolution	Accuracy	Part No.	Reg. Net Price	SALE!
0-12" (0-300mm)	.0005" (0.01mm)	±.0015"	1-808-570412	\$1,033.00	\$878.05
0-18" (0-450mm)	.0005" (0.01mm)	±.002"	1-808-570413	1,383.00	1,175.55
0-24" (0-600mm)	.0005" (0.01mm)	±.002"	1-808-570414	1,610.00	1,368.50

Digital Count Dial Height Gage & Surface Plate Set

HEIGHT GAGE FEATURES:

- Graduation: .001".
- Dial Reading Digital Counter: 0.1".
- Double digital counter can be zero-set at any height within range by depressing zero-set button.
- Features a large feed wheel for coarse and fine vertical adjustments.
- Bottom surface hardened and ground.
- Carbide tipped scribe.

SET INCLUDES:

- Digital Count Dial Height Gage with Dual Directional Counters: 0-12".
- "B" 0-Ledge Granite Surface Plate: 12" x 18" x 3".

Part No. **8-135-9100**
Reg. Net Price \$452.25
\$339¹⁹



save 25%

OVERSTOCK SALE!
Quantities Limited.



1-2-3 Block Pair With 1 Hole Per Block



Ideal for mounting work for precision grinding and layout.

FEATURES:

- Parallelism: $\pm .0002"$
- Precision ground and hardened on all sides.
- Hardness HRC 56-60.



1" x 2" x 3"

Part No. 1-806-003H
Reg. Net Price \$35.41

\$28³³

Mitutoyo Pro360 Digital Protractor Series 950



FEATURES:

- Reading hold.
- Minimal cross axis error.
- Full 360° range (90° x 4).
- Alternate reference (zero).
- Machined aluminum frame.
- Simple calibration requiring no special fixtures.
- Display remains upright to view at all angle.
- Standard 9V Battery: Approx. 500 hrs.
- Supplied in a fitted carrying case.

SPECIFICATIONS:

950-317
Range 360° (90° x 4)
Resolutions1°
Accuracy $\pm 0.1^\circ$ Level $\pm 10^\circ$, Plumb $\pm 10^\circ$,
..... $\pm 0.2^\circ$ Maximum Error
Repeatability $\pm 1^\circ$
Weight 10.2 oz

Part No. 1-808-950317 **\$346⁸⁰**
Reg. Net Price \$408.00

3 Pc. Machinist Square Set



FEATURES:

- Hardened spring steel blades.
- Precision ground and lapped.
- Manufactured to DIN 875-1 standard specification.



Supplied with a protective case.

Includes: 2", 4", 6"

Part No. 1-815-220

Reg. Net Price \$92.67

\$74¹⁴



Starrett® Steel Straight Edges Series 380



FEATURES:

- 36" and longer are marked with arrows at two suspension points.
- Precision ground and nicely finished to rigid standards.
- Their thickness and design permit them to retain shape and accuracy, yet still portable and easy to handle.
- No. 380 series are not beveled or graduated.

Length		Width x Thickness		Starrett No.	Part No.	Reg. Net Price	SALE!
Inch	mm	Inch	mm				
12	300	1-13/32 x 11/64	36 x 4.4	380-12	1-855-51438	\$107.00	\$94.16
24	600	1-13/32 x 11/64	36 x 4.4	380-24	1-855-51440	165.00	145.20

12 Pc. Angle Block Sets



FEATURES:

- Size: 3" long x 1/4" thick.
- Accuracy: .0001"/in.
- Hardened and precision ground steel.
- Eliminates calculations, avoids errors.
- Supplied with a fitted case.



1°, 2°, 3°, 4°, 5°, 10°, 15°,
20°, 25°, 30°, 1/4° & 1/2°

Part No. 1-801-055

Reg. Net Price \$119.38



\$95⁵⁰



Sheet Metal Gage U.S. STANDARD

FEATURES:

- Hardened and tempered tool steel.
- For gaging uncoated sheet, plate iron, and steel.
- Measures from 0 to 36 or decimal equivalents on reverse side.

1/8" Thick x 3-1/4" Dia.

Part No. 1-804-5058

Reg. Net Price \$60.30

\$51²⁶



Acme Screw Pitch Gage



FEATURES:

- Stainless steel.
- 29° included angle.
- 16 leaves all linked on one side.

Part No. 1-999-030

Reg. Net Price \$46.93

\$39⁸⁹

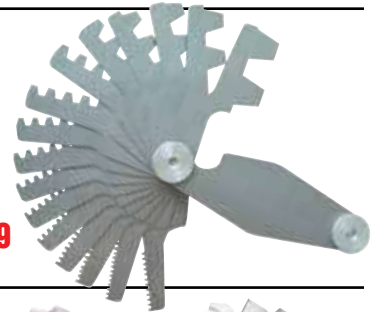

Screw Pitch Gages



FEATURES:

- Quickly determine the pitch of various threads.
- Made of high quality polished tool steel.
- A locking device at both ends to securely lock the leaves.
- All leaves clearly marked with size.

Range	Pitches	Part No.	Reg. Net Price	SALE!
4-42 TPI	31	1-999-005	\$9.53	\$8.10
.25-2.5mm	28	1-999-010	9.53	8.10
4-84 TPI	51	1-999-015	27.06	23.00



Starrett®

5 Pc. Telescoping Gage Set

Series 229

FEATURES:

- Used for determining the true size of holes, slots and recesses up to 6" (150mm).
- Final hole size is obtained by measuring over the gage contacts with a micrometer.
- These gages feature a handle, 1 rigid contact arm, and 1 spring-tensioned telescoping contact arm.



Starrett No. S229GZ
Range: 1/2" to 6"

Part No. 1-855-50929

Reg. Net Price \$411.00

\$349³⁵



3" Feeler Gages

FEATURES:

- Number of Blades: 26.
- Blades made of finest feeler gage stock, hardened and tempered.
- Each blade marked with thickness.
- Steel case protects blades.
- Lock nut holds blades securely in place.

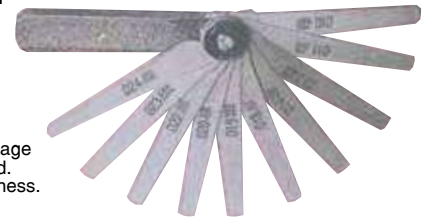

Straight
1/2" Wide At Tip

Part No.
1-804-519

Reg. Net
Price \$39.81

\$33⁸⁴

Tapered
1/4" Wide At Tip

Part No.
1-804-520

Reg. Net
Price \$39.81

\$33⁸⁴

THICKNESSES INCLUDED:

.0015, .002, .0025, .003, .004,
.005, .006, .007, .008, .009,
.010, .011, .012, .013, .014,
.015, .016, .017, .018, .019,
.020, .021, .022, .023, .024, .025"



PALMGREN

7" x 12" Horizontal Bandsaw

1 HP, 120/240V, 1 PH Motor

FEATURES:

- Automatic shut off at end of cut.
- Chip brush and rapid acting vise.
- Adjustable material work stop.
- Adjustable ball bearing blade guides delivers straight accurate cuts.
- Flood coolant system cools and cleans chips from the blade.

SPECIFICATIONS:

Capacity at 45°
 Rectangle 7" x 11-3/4"
 Round 7"
 Square 7"
 Speeds (4) 96/132/178/260 FPM
 Blade Size 3/4" x 0.035" x 93"



Model 83311
Part No. 1-549-83311
\$3,787⁵²
 AS LOW AS \$90.27/mo.



7" x 12" Dual Swivel Horizontal Bandsaw

1 HP, 220V, 1 PH Motor

2 FULL YEAR WARRANTY

Saw Blade & Coolant System Included!

FEATURES:

- Saw bow swivels 45° right and left.
- Portable - Take to the job and plug it in.
- Hydraulic feed control.

Model KC-712DS
Part No. 6-125-043
\$3,599⁰⁰

AS LOW AS \$85.78/mo.

SPECIFICATIONS:

Blade Size 3/4" x 93"
 Capacity Rectangular 7" x 12"
 Capacity Round 7"
 Motor 1 HP, 220V, 1 PH
 Blade Speeds (4) 85-235 RPM



Automatic Cycle Bandsaws

FEATURES:

- Full auto cycle.
- 3 HP drive motor.
- 1" bi-metal blade.
- Cast iron construction.
- Net Weight: 1,800 or 2,200 lbs.
- Shipping Weight: 2,000 or 2,500 lbs.

AS LOW AS \$000.00/mo.



Model BS-12A
 12" Round Capacity
 (230/460V, 3 PH)
Part No. \$21,950⁰⁰
 6-275-007

Model BS-12A
 12" Round Capacity
 (575V, 3 PH)
Part No. \$21,950⁰⁰
 6-275-007C



Model BS-15A
 15" Round Capacity
 (230/460V, 3 PH)
Part No. 6-275-009
\$26,175⁰⁰

Model BS-15A
 15" Round Capacity
 (575V, 3 PH)
Part No. 6-275-009C
\$26,175⁰⁰



10" x 18" Horizontal Bandsaw

FEATURES:

- Powerful 2 HP drive motor.
- Infinitely adjustable hydraulic feed control.
- Built-in coolant system.
- Precision dial gage display for proper blade tensioning.

Model KC227-2
 (230V, 1 PH)
Part No. \$5,999⁰⁰
 6-125-044

Model KC227-2
 (575V, 3 PH)
Part No. \$5,999⁰⁰
 6-125-044C
 AS LOW AS \$135.51/mo.



SPECIFICATIONS:
 Round Capacity at 45° / 90° 10"
 Rectangular Capacity at 90° 10" x 18"
 Rectangular Capacity at 45° 7" x 9-3/8"
 Blade Size 1" x 122"
 Blade Speed (4) 114-377 SFPM

2 FULL YEAR WARRANTY

TENNSMITH 52" 16-Gauge Foot Squaring Shear

Model 52
Part No. 6-700-010

\$6,140⁰⁰

AS LOW AS \$138.70/mo.

F.O.B. FACTORY — TENNESSEE

Hi-Carbon, Hi-Chrome Steel Blades Included!

3 FULL YEAR WARRANTY



FEATURES:

- Upper and lower shear blades with unique adjustment features.
- Shear frame, bed and cutter head constructed of heavy-duty cast iron.
- Double-locking back gauge with embossed scales and vernier wheels for fine adjustment standard.

SPECIFICATIONS:

Back / Front Gauge Range 30" / 37"
 Max. Cutting Length 52-1/4"
 Dimensions (less gauge) 61" x 36" x 42"
 Floor Space, Gauges in Position 60" x 80"

TENNSMITH Universal Box & Pan Brake With Stand

AS LOW AS \$81.27/mo.

F.O.B. FACTORY — TENNESSEE



MODEL HBU48-16

SPECIFICATIONS:

	HBU48-22	HBU48-16	HBU48-12
Capacity (mild steel).....	22 GA.	16 GA.	12 GA.
Bending Length.....	48-1/4"	48-1/4"	48-1/4"
Maximum Depth of Body.....	3"	4"	4"
Maximum Lift of Beam.....	7/8"	1-1/4"	1-1/2"
Front to Rear Beam Adjustment.....	1/8"	5/8"	1"
Minimum Reverse Bend.....	5/16"	1/4"	1/4"
Min. Flange in Cap. Material.....	3/8"	1"	1"
Finger Widths.....	2, 3 & 4"	2, 3 & 4"	2, 3 & 4"

Model HBU48-12
Part No. \$8,445⁰⁰
 6-700-045

Model HBU48-16
Part No. \$3,410⁰⁰
 6-700-040

Model HBU48-22
Part No. \$2,245⁰⁰
 6-700-035



MODEL HBU48-12

nova™ 7" x 12"
Nova Eclipse
DVR Metal Cutting
Bandsaw

1 HP, 120V, 1 PH Motor

FEATURES:

- Smart metal bandsaw combines common bandsaw features with state of the art technology.
- Powerful direct drive 1 HP high torque brushless motor without pulleys or belts to cause vibration.
- Digital Variable Reluctance (DVR) Direct Drive Technology with Adaptive Control™ Software.
- Includes a 240V conversion components kit which increases the HP of the motor.
- TRU-LOCK quick locking clamping vise system.

COMPLETE WITH:

- Blade.
- USB cable.
- Workstop.
- Adjustment Wrenches.
- Firmware.
- Vertical Saw Table.

SPECIFICATIONS:

Cutting Capacity:

90° Rectangular/Round	7" x 12"/7"
45° Rectangular/Round	4-1/2" x 5"/5"
Speeds	80-340 FPM
Blade	93" x 3/4" x 0.032"
Motor	15 AMP, 120V, 1PH, 60 Hz

World's First Smart Bandsaw

Digital Variable Reluctance (DVR) Direct Drive Technology with Adaptive Control Software for optimum results for superior finish.



NEW!

Model 59001

Part No. 6-125-080 **\$3,499⁰⁰**

AS LOW AS \$83.40/mo.



14-1/2" Capacity
Gravity Feed
Vertical Saw

1 HP, 115V, 1 PH Motor

FEATURES:

- Speeds (4): 70-525 SFPM
- Rugged simple construction for easy maintenance and long service life.
- Accurate gravity feed with hydraulic speed control and depth stop.
- Accepts blades from 1/4"-3/4" wide.

Model EF-1459

Part No. 6-398-005

\$12,472⁰⁰

AS LOW AS \$274.37/mo.



Variable Speed
Vertical Bandsaws

with Blade Welder & Power Table Feed

FEATURES:

- Use heavy cast iron blade wheels with rubber tire liners for traction and quiet operation.
- Built on cast iron frames with heavy duty construction throughout.
- Infinitely variable blade speeds so you can select the most efficient cutting speed for a wide variety of materials.
- Cast iron table with variable electric power table feed (12-1/2" travel).



AS LOW AS \$300.62/mo.



MODEL BAV-500PF

COMPLETE WITH:

- Work light, chip blower, bandsaw blade, grinding wheel, built-in blade welder, variable blade speeds, rubber tires for blade wheels, and variable electric power table feed.



18" Vertical
Bandsaw

1 HP, 220V, 1 PH Motor

Model KC-450

Part No. 6-125-047

\$5,499⁰⁰

AS LOW AS \$124.22/mo.

FEATURES:

- Variable Blade Speed: 82-384 FPM
- Infinitely variable speeds allows selection of the most efficient speed (FPM) for each piece.
- 18" W x 10" H capacity.
- Cast iron blade wheels with rubber tires for traction are mounted on shafts with taper roller bearings.
- Large cast iron work tables tilt R & L / F & B.

COMPLETE WITH: Built-in blade welder with grinder wheel, work light and blade shear that welds blades up to the saw capacity.



2 FULL YEAR WARRANTY

Jaws 55 Ton
Punch Pressure
Ironworker

5 HP, 575V, 3 PH Motor

Hydraulic powered punching capacity with open tooling station, built-in stations for shearing plate and angle iron.

Call us for punches & dies and all the other available accessories for these versatile machines.

Model 55T
 Part No. 6-700-215C



SPECIFICATIONS:

Max. Capacity	1-3/8" Dia. -1/2" Plate
Largest Standard Punch/Die	1-1/16"/1-1/4"
Bar Shear Rounds/Squares	1-1/8"
Max. Flat Thickness	3/4" x 4"
Max. Flat Width	1/2" x 12-3/8" x 14"
Max. Angle Shear Size	3" x 3" x 3/8"

CALL FOR PRICING!
TOO LOW TO ADVERTISE!

While Supplies Last.



12" Slow Speed
Cold Cut Saw

4-1/2 HP, 220V, 1 PH Motor

2 FULL YEAR WARRANTY

FEATURES:

- Low 52 RPM blade speed is ideal for cutting ferrous metals.
- Mitering head pivots to the right or left positive stops at 45° & 90°.
- Quick action clamping vice secures workpiece.
- Control handle with integrated safety trigger.

SPECIFICATIONS:

Cutting Capacity	
Solid Round	2-3/8" / 2"
Hollow Round	4" / 3-1/2"
Square	3-1/4" / 3-1/4" / 3" x 3"
Spindle Speed	52 RPM
Max. Vise Opening	4-3/4"

COMPLETE WITH: Side roller, anti-splash guards, coolant system, and workshop assembly.

Model KC-315CS
 Part No. 6-125-036

\$3,299⁰⁰

AS LOW AS \$78.63/mo.

12" Blade Not Included.

Optional 12" Cold Cut Saw Blade

Model KM-1200
 Part No. 6-125-KM1200 **\$359⁰⁰**



Click here for complete details.



7" x 12" Variable Speed Mini Lathe

110V, 1 PH Motor

FEATURES:

- Bed ways are hardened and precision ground.
- Clear plastic safety guard automatically shuts lathe off when lifted.
- Power feed of apron along the bed towards the chuck.

SPECIFICATIONS:

Distance Between Centers.....12"
 Spindle Bore.....3/4"
 Spindle Speeds (var.).....0-2,500 RPM
 Spindle Taper.....3 MT
 Swing Over Bed/Cross Slide.....7 1/4-1/2"
 Tailstock Spindle Taper.....2 MT
 Thread Range.....12-52 TPI

Model KC0712ML

Part No. **\$1,099⁰⁰**



COMPLETE WITH: 3-Way jaw chuck, 4-way tool post, thread dial indicator rear chip guard, e-stop button, and centers.

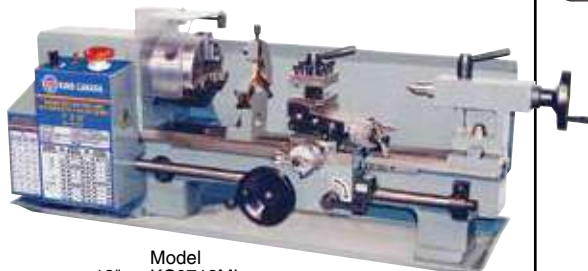

16" x 40" High Precision Toolroom Metal Lathe

4 HP, 575V, 3 PH Motor

FEATURES:

- Powerful 4 HP drive motor.
- Gearhead spindle drive with hardened and ground gears.
- Bedways hardened and precision ground.
- 4-way power feed.
- Inch/metric graduated dials.
- Lathe chuck safety guard automatically shuts lathe off when lifted.
- Speeds (16) 45-1,800 RPM.

Model KC-1640ML
 Part No. 6-125-064C

\$16,999⁰⁰



AS LOW AS \$370.24/mo.

COMPLETE WITH: 12" 4-Jaw chuck, 8" 3-jaw chuck, work light, e-stop button, full-length rear chip guard, coolant system, & thread dial indicator.

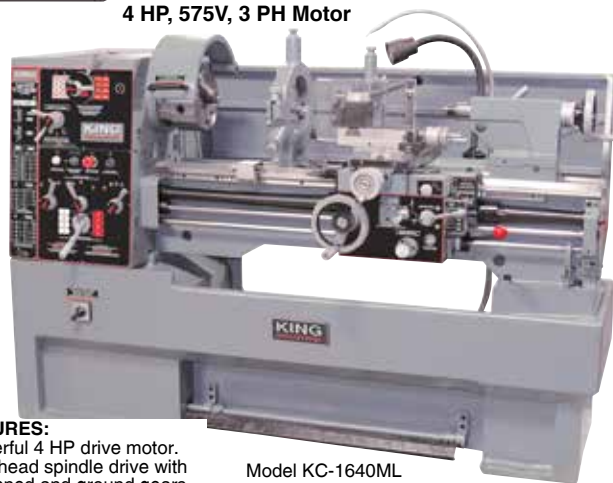

12" x 36" Gearhead Metal Lathe

1-1/2 HP, 220V, 1 PH Motor

FEATURES:

- Line interruption switch system needs a restart after a power failure.
- Guideway and gears in headstock are all hardened and precision ground.
- Safety guard with limit switch protection.

Model KC1236ML
 Part No. 6-125-063

\$5,999⁰⁰

AS LOW AS \$135.51/mo.

COMPLETE WITH: 6" 3-Jaw chuck, 8" 4-jaw chuck, 1/2" drill chuck, 3MT dead center and arbor taper, 10" DI-4 camlock face plate, steady and follow rest, imperial and metric gears, quick-change tool post, full length splash guard, chuck and hex keys, and thread chasing dial indicator.



17" x 40" Heavy-Duty Precision Lathe

7-1/2 HP, 230/460V, 3 PH Motor



Model ML-1740T
 Part No. 6-273-064

\$33,000⁰⁰

With NEWALL NMS-300 Digital Readout Installed
 Part No. 6-273-064-N3

\$35,270⁰⁰

AS LOW AS \$690.75/mo.

FEATURES:

- Centralized lube system in headstock.
- D1-6 camlock, 3-1/8" spindle bore.
- Speeds (12) 36-1,800 RPM.
- Hardened and ground gears and bedways.

COMPLETE WITH: 10" 3-jaw chuck, steady and follow rest, 4-way tool post, halogen work light, and coolant system with full length rear splash guard.



14" x 40" Gearhead Metal Lathe

2 HP, 240V, 1 PH Motor

Model KC1440ML-2
 Part No. 6-125-062A

\$9,499⁰⁰

AS LOW AS \$214.57/mo.

FEATURES:

- Line interruption switch system needs a restart after a power failure.
- Guideway and gears in headstock are all hardened and precision ground.
- Safety guard with limit switch protection.
- Spindle foot brake in the cabinet stand for easy operation and reliable safety.
- Speeds (8): 70-2,000 RPM.



NEWALL NMS-300 2-Axis Digital Readout



18" x 60" High Precision Engine Lathe

7.3 HP, 230/460V, 3 PH

FEATURES:

- 7.3 HP main spindle motor, 12 speeds.
- D1-8 camlock, 3.2" spindle bore.
- Solid one-piece cast iron base.
- Hardened & ground gears & bedways.
- Centralized lube system in headstock.
- Inch dials and leadscrews.
- Full-length safety foot brake.

Model KLS-1860G
 Part No. 6-273-071

\$27,250⁰⁰

With NEWALL NMS-300 Digital Readout Installed
 Part No. 6-273-071-N3

\$29,700⁰⁰

AS LOW AS \$570.39/mo.

COMPLETE WITH: Follow rest, 2-way rapid traverse on apron, coolant system with full length rear splash guard, 4-position carriage stop, and 4-way indexable toolpost.

KENT USA Large Bore Engine Lathes
10 HP, 230/460V, 3 PH Motor

Big 4" Spindle Bore,
Clutch Spindle Drive and
4-Way Rapid Traverse.

FEATURES:

- 10 HP main spindle motor, 12 speeds.
- Centralized lube system in headstock.
- Hardened and ground gears and bedways.
- D1-8 camlock, 4.12" spindle bore.
- Jog button, 4-way rapid traverse.
- Inch dials and leadscrews.
- Clutch style headstock.
- Safety foot brake.

SPECIFICATIONS:

- Swing Over Bed 22" / 26"
- Swing Over Cross Slide 12.5 / 16.5"
- Distance Between Centers 60" / 80" / 120"
- Spindle Speed (Range 12) 36-1,600 RPM
- Spindle Nose / Bore D1-8 / 4.12"
- Threads Standard (32) 2-28 TPI
- Threads Metric Pitch (22) 1-14mm
- Tailstock Quill Travel/Taper 6" / 5MT



COMPLETE WITH:

- 12" 3-Jaw Chuck.
- 16" 4-Jaw Chuck.
- Work Light.
- 8" Steady Rest.
- 1-3" Follow Rest.
- 4-Way Toolpost.
- Thread Chasing Dial.
- Full-Length Splash guard.
- Coolant System.

AS LOW AS
\$706.45/mo.

Model KLS-2260C (22" x 60")
Part No. 6-273-067

\$33,750⁰⁰

With NEWALL NMS-300
Digital Readout Installed
Part No. 6-273-067-N3 **\$36,200⁰⁰**

Model KLS-2280C (22" x 80")
Part No. 6-273-068

\$35,000⁰⁰

With NEWALL NMS-300
Digital Readout Installed
Part No. 6-273-068-N3 **\$37,825⁰⁰**

Model KLS-26120C (26" x 120")
Part No. 6-273-069

\$41,600⁰⁰

With NEWALL DP-700
Digital Readout Installed
Part No. 6-273-069-N **\$49,750⁰⁰**



NEWALL
NMS-300 2-Axis
Digital Readout



NEWALL
DP-700 2-Axis
Digital Readout

PALMGREN Belt Grinder

FEATURES:

- Belt is adjustable for use in either the vertical or horizontal position or any position in-between.
- Front mounted on/off paddle switch.
- Simple belt tensioning and adjustment.
- Full belt guard and dust collection port.

SPECIFICATIONS:

- Belt Size 1" x 42"
- Belt Speed 1,800 SFPM
- Motor 1/2 HP, 120/240V

Model 82401
Part No. 1-549-82401
\$604⁸⁷



KALAMAZOO 2" Belt Sander

1/2 HP, 115V, 1 PH Motor

FEATURES:

- 2" x 48" Belt.
- Multi-position sanding head.
- Hinged guard for quick belt change.
- Removable & adjustable 0-45° steel work table.
- Shipping Weight (approx.): 50 lbs.

Part No. 2-002-2FSM
\$983⁶⁰



KENT USA 10" x 20" 3-Axis Auto Feed Surface Grinder
2 HP, 230/460V, 3 PH Motor

FEATURES:

- Precision hand scrapped turcite table and saddle ways.
- Rapid elevation motor for quick and easy positioning.
- 3-axis automatic movement with incremental downfeed in .0001" steps.
- High column design with 19" spindle center to table.
- 10" x 20" grinding capacity.
- Auto. lubrication system.

Model SGS-1020AHD
Part No. 6-273-015
\$39,000⁰⁰



AS LOW AS
\$816.34/mo.

COMPLETE WITH:

- 8" x 20" Magnetic chuck, dust-suction, coolant system, and overhead parallel dresser.

KENT USA 10" x 20" 3-Axis Automatic Surface Grinder
3 HP, 230/460V, 3 PH Motor

- COMPLETE WITH:**
• 8" x 20" Permanent magnetic chuck, and flood coolant system with splash guards.

AS LOW AS
\$659.35/mo.

FEATURES:

- 3-axis automatic with incremental downfeed and electronic auto crossfeed.
- Precision cartridge type direct drive spindle (3,500 RPM).
- Heavy cast iron base absorbs vibration.
- Automatic lubrication.
- Wheel Size: 8" x 1" x 1-1/4".

Model KGS-1020AHD
Part No. 6-273-012
\$31,500⁰⁰



KENT USA 12" x 30" 3-Axis Auto Feed Surface Grinder
5 HP, 230/460V, 3 PH Motor

AS LOW AS
\$1060.17/mo.

COMPLETE WITH:

- Electric chuck, dust-suction coolant, over head parallel dresser, auto lubrication system, wheel balancing base, and arbor.

Model SGS-1230AHD
14" x 1-1/4" x 5" Wheel
Part No. 6-273-020
\$51,750⁰⁰



KING INDUSTRIAL 3" x 79" Metal Belt Sander



Click here for complete details.

FEATURES:

- Motor: 2 HP, 220V.
- Horizontal working height of 36".
- Hinged top cover for access to entire length of belt for larger pieces.
- Comes with 80 grit pure zirconium sanding belt.
- Sanding belt rotates on 7-1/2" vented drive wheel and solid rubber rear wheel for maximum tracking and sanding control.

Model KC-379MS
Part No. 6-125-007
\$999⁰⁰

KING 3" Disc & Belt Sander
1 HP, 115V, 1 PH Motor

FEATURES:

- Can be switched from horizontal to vertical.
- Table can be switched from disc side to belt side and tilts 45° right and left.
- Heavy-duty cast iron construction.

2 FULL YEAR WARRANTY

Model KC-760L
Part No. 6-125-003
\$499⁹⁹

- COMPLETE WITH:** Miter gauge, 2-1/2" to 4" dust chute adapter, and sturdy enclosed cabinet stand.

SPECIFICATIONS:

- Belt Size / Speed 6" x 48" / 1,250 SFPM
- Disc Size / Speed 9" / 1,740 RPM
- Dimensions 30" x 19" x 56"





18" Nova Voyager DVR Drill Press

1 HP, 115V, 1 PH Motor

FEATURES:

- Digital Variable Reluctance (DVR) Direct Drive Technology with Adaptive Control™ Software which works for you to produce optimum results in wood, metal, plastic and glass.
- Constant torque under load, depth and vibration sensors and emergency stop.
- Slow start pilot hole, tapping assist with chip breaking cycle and self start functions.
- Electronic braking and forward/reverse.

SPECIFICATIONS:

Chuck Size 5/8"
 Drilling Capacity 5/8"
 Swing 18"
 Spindle Taper 2 MT
 Speeds (Var.) ... 50-3,000 RPM

COMPLETE WITH: 5/8" Drill chuck and key, firmware USB cable, knock-out wedge, adjustment wrench, & hex keys.



NEW!

Model 58006
 Part No. 6-125-076
\$2,399⁰⁰

[Click here for complete Nova listing & details.](#)



8" Bench Drill Press

115V, 1 PH

2 FULL YEAR WARRANTY

SPECIFICATIONS:

Drill Chuck & Arbor 1/2"
 Max. Distance Chuck to Base 10"
 Max. Distance Chuck to Table 7"
 Speeds (5) 620-3,100 RPM
 Spindle Taper / Travel JT #33 / 2"



Model KC-108N
 Part No. 6-125-019
\$159³⁹



13" Drill Press

1/2 HP with Dual Laser Guide System

2 FULL YEAR WARRANTY

FEATURES:

- Locking depth stop for repetitive blind hold drilling.
- 5/8" drill chuck and key included.
- 45° tilting table for angular drilling.
- Light socket incorporated into drill press head.

SPECIFICATIONS:

Stroke 3-1/8"
 Table Size 12-13/16"
 Spindle Taper 2 MT
 Speeds (16) 220-3,600 RPM

Model KC-116N
 Part No. 6-125-020
\$429⁹⁹



22" Drill Press

With Safety Guard
 1 HP, 115V, 1 PH Motor

FEATURES:

- Powerful 1 HP motor.
- 45° tilting table for angular drilling.
- Chuck safety guard with microswitch prevents spindle from running unless guard is in place.
- Line interruption electromechanical switch and safety guard with limit switch protection.

SPECIFICATIONS:

Drilling Capacity Steel 1-1/4"
 Chuck Size 3/4"
 Swing 22"
 Table Size 18-3/4" x 16-1/4"
 T-Slot Size 5/8"
 Spindle Taper 4MT
 Speeds (12) 180-4,200 RPM



COMPLETE WITH: Drill chuck and arbor, work light socket (less bulb), chuck safety guard with limit switch, manual and parts list.

Model KC-122FC-LS
 Part No. 6-125-029
\$1,299⁰⁰

2 FULL YEAR WARRANTY

World's First Smart Drill Press

nova™ 16" Nova Viking DVR Drill Press

1 HP, 120V, 1 PH Motor

NEW!

FEATURES:

- Digital Variable Reluctance (DVR) Direct Drive Technology with Adaptive Control™ Software which works for you to produce optimum results in wood, metal, plastic and glass.
- Automatic electronic depth stop, quickly and accurately stops to the precise programmed depth.
- Electronic braking and forward/reverse.
- Intelligent speed selection and dial knob for precise speed adjustments.
- Convenient LED light and twin laser guide system.

COMPLETE WITH:

5/8" Drill chuck & key, firmware USB cable, knock-out wedge, adjustment wrench, and hex keys.

SPECIFICATIONS:

Chuck Size 5/8"
 Drilling Capacity 5/8"
 Swing 16"
 Spindle Taper 2 MT
 Speeds (Var.) 150-3,000 RPM



Model 83705
 Part No. 6-125-075
\$1,699⁰⁰

Digital Variable Reluctance (DVR) Direct Drive Technology with Adaptive Control Software for optimum results for superior finish.

PALMGREN 17" Heavy-Duty Step Pulley Drill Press

1 HP, 120/240V, 1 PH Motor

FEATURES:

- Front mounted industrial paddle-type power switch.
- LED readout of spindle speed and quill travel.
- Precision ground t-slotted work table with coolant trough.
- Extended quill/spindle travel ideal for deep hole applications.
- Table tilts 45° right and left and rotates 360° around the column.
- Quick change vertical depth stop for accurate, repeatable feed length.
- Includes chuck with key and arbor.

Model 80177
 Part No. 1-549-80177 **\$2,301⁴⁸**

3 YEAR

SPECIFICATIONS:

Spindle Taper / Travel 2 MT / 5"
 Table Size 14-3/8" x 14-3/8"
 Number of Speeds 16
 Speed Range 138-3,476 RPM



Radial Drill Press

2 HP, 230/575V, 3 PH Motor



Box Table, Coolant System & Work Light Included!

\$21,115⁰⁰

Model RD-750
 (230V, 3 HP)
 Part No. 6-269-010

AS LOW AS \$454.78/mo.

Model RD-750
 (575V, 3 HP)
 Part No. 6-269-010C

FEATURES:

- Geared spindle drive with six speeds selected by change levers.
- Three spindle feed rates selected by a single knob.
- Motorize power arm elevation.

SPECIFICATIONS:

Column Diameter 8-1/4"
 Distance Spindle/Column 30-1/2"
 Drilling Capacity 1-1/2"
 Overall Height 85-5/8"
 Quill Travel 7-7/8"
 Spindle Taper 4 MT



6" x 26" Vertical Milling Machine 1 HP, 115V, 1 PH Motor

FEATURES:

- Dovetail ways with adjustable tapered gibs under the table and saddle 7 on the column face.
- Turret head tilts to either side 90° and swivels 120° right or left.
- Spindle feeds with a manually operated rapid feed lever or a fine feed handwheel.

Model VM-12-R8
Part No. 6-380-001 \$6,280⁰⁰
 AS LOW AS \$141.86/mo.



COMPLETE WITH: FREE Cabinet floor stand, work light, front and rear rubber way covers, and drawbar for R8 collets.

SPECIFICATIONS:

Spindle Taper R8
 Quill Travel 2-3/4"
 Spindle Speeds (9)..... 230-2,520 RPM
 Long. / Cross Travel..... 14-1/2" / 6"
 Table Size 6" x 26"

7" x 31" Universal Vertical Milling Machine 1-1/2 HP, 115V, 1 PH Motor

FEATURES:

- Spindle feeds with a manually operated rapid feed lever or a fine feed handwheel.
- Dovetail ways with adjustable tapered gibs under the table and saddle and on the column face.
- Turret head tilts to either side 90° and swivels 120° right or left.

Model VM-22-R8
Part No. 6-380-002 \$7,985⁰⁰
 AS LOW AS \$180.37/mo.



COMPLETE WITH: Front and rear rubber way covers, drawbar for R8 collets, and more!

SPECIFICATIONS:

Max. Distance, Spindle to Table 20"
 Spindle Taper R8
 Spindle Speeds (9)..... 270-3,200 RPM
 Quill Travel 3-1/8"
 Cross Slide Travel 8"
 Longitudinal Travel 17-5/16"
 Vertical Knee Travel 21-1/2"
 Table Size 7" x 31-1/2"

KING INDUSTRIAL Bench Model Milling/Drilling Machine 1-1/2 HP, 220V, 1 PH Motor

FEATURES:

- Manual quill feed both rapid spoke wheel and fine feed hand-wheel control with an easy-to-read front mounted depth gauge.
- Handwheel dials graduated in 0.001" increments.
- Dovetail ways on table and saddle with adjustable tapered gibs.



Model PDM30
Part No. 6-125-030 \$2,999⁰⁰
 AS LOW AS \$71.48/mo.



COMPLETE WITH: 3" Face mill, safety guard, 3-1/2" angle vise, drawbar for R8 collets, rear rubber way cover, & 1/2" capacity drill chuck.

SPECIFICATIONS:

Drilling / End Mill Capacity 1-1/4" / 3/4"
 Swing 15-7/8"
 Max. Distance, Spindle to Table 18-7/8"
 Spindle Taper / Travel R8 / 5"
 Spindle Speeds (12)..... 150-2,500 RPM
 Table / Cross Slide Travel 17" / 7-1/4"
 Effective Table Area 28-3/4" x 8-1/4"
 Overall Height 43"

KING INDUSTRIAL 2 HP Metal Dust Collector

Ideal for metal chips and dust from sanders, grinders, cold saws, and chamfering.

Model KC-7300C
Part No. 6-125-015 \$1,699⁰⁰



FEATURES:

- Powerful 2 HP, 220V motor.
- Noise Level Reading at 60": 81 dB
- Large metal chips collection drawer.
- 2 step activation safety switch with line voltage interruption in case of power failure.
- 6" inlet with Y-inlet adapter with (2) 3" dust inlets connecting up to 2 metalworking machines.
- Comes with large paper filter and iron activated carbon filter.



9" x 49" Turret Milling Machines

Model TUM-1VS (230V, 3 PH)
Part No. 6-265-007

\$13,285⁰⁰



With NEWALL NMS-300 DRO & Table Feed Installed
Part No. 6-265-007-N3 \$16,785⁰⁰

Model TUM-1VS (575V, 3 PH)
Part No. 6-265-007C

\$13,285⁰⁰

AS LOW AS \$292.26/mo.

With NEWALL NMS-300 DRO & Table Feed Installed
Part No. 6-265-007C-N3 \$16,785⁰⁰

SPECIFICATIONS:

Longitudinal Travel Manual Model 35"
 Longitudinal Travel w/ Power Feed 31"
 Cross Travel / Knee Travel 12" / 16"
 Table To Spindle (min-max.) 0-18-3/4"
 Spindle To Column at 90° ... 6-3/4"-18-3/4"
 Speeds (Var.) 70-4,200 RPM
 Spindle Taper R8
 Power Quill Feeds (per rev.) 0.0017"/.0032"/.0053"
 Quill Travel 5"
 Spindle Motor .. 3 HP, 230V or 575V, 3 PH

MODEL TUM-1VS Shown with Newall NMS-300 and KBC Table Feed.



3 HP Variable Speed Head!

NEWALL NMS-300 2-Axis Digital Readout



10" x 54" Heavy-Duty Milling Machines

Model TUM-3VS (230V, 3 PH)
Part No. 6-265-006

\$14,415⁰⁰

With NEWALL NMS-300 DRO & Table Feed Installed
Part No. 6-265-006-N3 \$17,915⁰⁰

Model TUM-3VS (575V, 3 PH)
Part No. 6-265-006C

\$14,415⁰⁰

With NEWALL NMS-300 DRO & Table Feed Installed
Part No. 6-265-006C-N3 \$17,915⁰⁰

AS LOW AS \$317.12/mo.

Model TUM-40VS (230V, 3 PH)
Part No. 6-265-009

\$16,995⁰⁰

With NEWALL NMS-300 DRO & Table Feed Installed
Part No. 6-265-009-N3 \$20,495⁰⁰

Model TUM-40VS (575V, 3 PH)
Part No. 6-265-009C

\$16,995⁰⁰

With NEWALL NMS-300 DRO & Table Feed Installed
Part No. 6-265-009C-N3 \$20,495⁰⁰



MODEL TUM-3VS Shown with Newall NMS-300 and KBC Table Feed.

SPECIFICATIONS:	TUM-3VS	TUM-40VS
Table Size	10" x 54"	10" x 54"
Longitudinal Travel Manual	32"	32"
with Power Feed	28"	28"
Cross Travel	16"	16"
Knee Travel	16"	16"
Spindle Speeds	70-4,200 RPM	70-4,200 RPM
Spindle Taper	R8	NST40
Quill Travel	5"	5"
Spindle Motor	3 HP, 3 PH	5 HP, 3 PH
Voltage	230/460V or 575V	230/460V or 575V



MODEL TUM-40VS 5 HP Motor, #40 NST Spindle Taper, Hardened & Ground Square Ways on Knee and Column.



Safety Glasses

VALUE



FEATURES:

- Exclusive Duramass® scratch-resistant coating.
- Universal nose bridge.
- Strong, lightweight polycarbonate lens block 99.9% ultraviolet rays.
- Flexible bayonet temple design for a comfortable fit during long use.
- Near total seal of eye orbit assures the highest level of protection.

Lens Description	Part No.	Reg. Net Price	SALE!
Clear	1-711-CK110	\$3.38	\$3.04
Grey	1-711-CK112	3.56	3.20
Rainbow Mirror	1-711-CK118	5.85	5.27

3M WorkTunes™ Wireless Hearing Protector

NEW!

With Bluetooth® Technology

save 25%



FEATURES:

- Safe Volume Control Technology allows for increased volume yet corrects to maintain safe levels over 8-hour workday.
- Rotary turning dial allows you to operate your Bluetooth® wireless technology enabled device from the headset, eliminating cords.
- MP3 compatible and enhanced AM/FM digital radio performance; saves up to 50 stations.
- Audio assist technology provides setup and operational guidance without having to remove the headset.
- Vented headband design with removable padding for use with hats.

NRR: 24 DB

Part No. 1-720-90542

Reg. Net Price \$268.46

\$201³⁵



Leather Welder Gloves

save 20%

FEATURES:

- Insulated.
- Fleece lining.
- Gauntlet cuff.
- Made of gray B grade split shoulder cow leather.
- 13" 1 pc. back, self hemmed, and have a full sock lining.

Size: Extra-Large

Part No. 1-700-004

Reg. Net Price \$15.48

\$12³⁸



LiftAll® LoadHugger Ratchet Tiedown Flat Hooks



Secure your loads with these quality tiedowns!

2" WIDE ASSEMBLIES:

- Long Handle Ratchet
- 18" Fixed End Length
- 30 ft. Standard Assembly Length
- Ultimate Strength - 10,000 lbs.
- Working Load Limit - 3,300 lbs.

LiftAll Code: 61002

Part No. 3-003-30001

Reg. Net Price \$72.65

\$61⁷⁵

PALMGREN 14" Horizontal Roller Material Support Stand

FEATURES:

- A clamping mechanism on the column allows for quick and easy height adjustments.
- Chrome-plated, 2" x 14" ball-bearing roller head is designed to smoothly move up to 2,000 lbs. of flat stock.
- Locking screws provide added safety.
- Made of heavy-duty cast iron and steel.

SPECIFICATIONS:

Height 23" to 38-1/2"
Base 15" x 16-1/2"
Weight 47 lbs.

Part No. 1-549-MSH14

Reg. Net Price \$328.73

\$295⁸⁶



EDGE TECHNOLOGY Pro Tram System

Square the head of a milling machine quickly and easily!

FEATURES:

- To use the Pro Tram simply lower unit to the table and adjust the head until both indicators read the same.
- Can be used with a sine bar or sine plate to adjust the head to precise angles.
- Large 2.2" easy-to-read indicator faces.
- Body made from red anodized aluminum.
- Indicator Repeatability: 0.0002"
- Indicator Graduation: 0.001"



1/2" Shank

Part No. 1-811-01000

Reg. Net Price \$203.40

\$172⁸⁹

- INCLUDES:
- Calibration Gage
 - Manual Gage
 - Padded Case

TASCO Nextera® Over-the-Head Earmuff



The most comfortable, highest powered muff type ear protector in the industry. Heavy weight, high band pressure and high cost are no longer necessary to get the best.

FEATURES:

- 2 point suspension for even pressure distribution.
- Sewn, foam filled head pad for optimal comfort.
- Soft-Seal™ ear cushions provide maximum acceptance & comfort.
- NRR = 30, highest rated anywhere.
- Tested at NVLAP accredited laboratory.
- Meets CSA Class AL.

Part No. 1-700T-3006

Reg. Net Price \$48.27

\$41⁰³



General Purpose Maintenance Sock

3" Dia. x 4' Long

Highly absorbent sock for industrial maintenance. You can absorb most non-aggressive fluids, oil or water based. The sock "skin" allows fluids to pass through quickly to the absorbent fill inside.

Box of 30

Part No. 1-835-706B

Reg. Net Price \$155.92

\$132⁵³



LOC-LINE Quick Set Shield Kit



Shield yourself from chips and coolant!

KIT INCLUDES:

- 14" Adjustable, 3/4" Loc-Line® arm.
- Fitting for fixed mounting.
- Magnetic base.

8-1/2" x 12"

Part No. 1-836-60527

Reg. Net Price \$66.53

\$53²²

save 20%



ALIGN Variable Speed Power Table Feed

ALIGN

Variable Speed Power Table Feed

save 20%

FEATURES:

- Electrical and mechanical parts are made for easy maintenance.
- Design assures long trouble-free life.
- Special electrical relay protects against damage caused by power failure.

SPECIFICATIONS:

Motor 110V, 50/60 Hz., 1 PH
Speed (4-160) Max. 200 RPM
Max. Torque 150 in./lbs.

Part No. 2-011-211

Reg. Net Price \$1,008.07

\$806⁴⁶



BluBird® 3/8" x 50' Retractable Air Hose Reel Kit

With 3' Lead-In Hose

REEL FEATURES:

- Solid brass fittings.
- L-Shaped base with groove reinforcement ensuring a stable support.
- 20 gauge powder coated steel construction.
- Horizontal and vertical wall mount options with adjustable guide arm. Can be mounted on wall, ceiling, and floor.
- Adjustable hose stopper and 4 non-sag rollers reduces hose abrasion. Complete with rubber gasket.
- Smooth auto-rewind with locking 12 point ratchet gearing system.

Model BBR3850
Part No. 1-838-105K

\$222.83



FREE KBC Blow Gun

- INCLUDES:
- (1) 1-397-600S: KBC Blow Gun.



RELIABLE

UBERLIGHT™ FLEX LED Task Light with Clamp

NEW!

Model #3200TL (Black)

Part No. 1-541R-002
\$79.00

FEATURES:

- Nine total light settings and 40% more luminous efficiency.
- 26.5" silicone gooseneck can hold virtually any shape.
- Includes a 270° rotational head for precision control.
- 9 different settings and 3 color settings (2700K, 4000K, 5000K).
- 7.5" Head, 4.75" LED Panel.
- Up to 600 Lumens and up to 60,000 hours of use.
- 6' USB Cord with 120V Adapter.
- cETLus Certified.



GUARDAIR® Xtra Thrust® Extended Reach Safety Air Guns

For Maximum Power



Venturi nozzle serves two purposes:

(1) Main air flow speeds up as it passes through the nozzle drawing in ambient air through the two side ports. The increased velocity and increased volume of air exiting the nozzle boosts the available thrust up to 250%.

FEATURES:

- Enhanced venturi nozzle delivers 250% more thrust compared to conventional air guns.
- Cleans hard to reach areas.
- Extended trigger for added comfort.

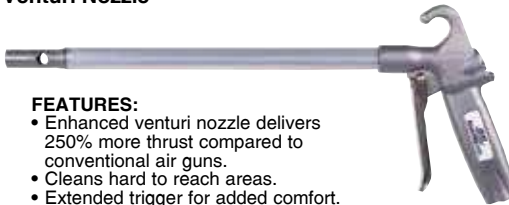

(2) Should the nozzle tip become blocked, all of the main air flow exits through the side ports. Under these conditions static pressure at the nozzle tip is held to less than 30 psi, thereby satisfying OSHA safety standards.

Model No.	Extension Length	Part No.	Reg. Net Price	SALE!
75XT 006 AA	6"	1-816G-XT006	\$58.95	\$50.11
75XT 012 AA	12"	1-816G-XT012	64.12	54.50
75XT 018 AA	18"	1-816G-XT018	66.69	56.69
75XT 024 AA	24"	1-816G-XT024	69.25	58.86
75XT 036 AA	36"	1-816G-XT036	74.40	63.24
75XT 048 AA	48"	1-816G-XT048	79.55	67.62
75XT 060 AA	60"	1-816G-XT060	84.70	72.00
75XT 072 AA	72"	1-816G-XT072	89.82	76.35

GUARDAIR® 1500 Gun Vac®

Serious cleaning power in the palm of your hands!

Great for all types of cleaning: Metal chips, plastic pellets, food crumbs, wood shavings, dirt and dust.

INCLUDES:
Gun Vac®, 9" Crevice Tool, & High Filtration Collection Bag.



Part No. 1-816G-1500
Reg. Net Price \$182.65

\$155.25



Machinery Mounts

LOW SERIES

FEATURES:

- Extra tough rigid design.
- Extra tough support screw.
- Complete range of sizes with long screw length.
- Solid finish quality rubber base.
- Supplied with bolts, nuts & washers.

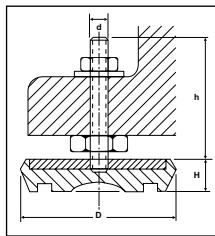

Load Per Mount/lbs.	Pad Dia. (D)	Pad Height (H)	Bolt Dia. (mm)	Bolt Length (h)	Part No.	Reg. Net Price	SALE!
0-130	1-5/8"	9/16"	8	1-1/2"	1-915-000B	\$7.04	\$6.34
70-220	2-3/8"	1 1/16"	10	3-1/4"	1-915-00B	12.93	11.64
180-300	3"	1 1/16"	12	3-1/2"	1-915-0B	15.54	13.99
300-700	3-3/8"	1"	12	3-1/2"	1-915-1B	19.68	17.71
700-1,200	4-5/16"	1-1/8"	16	4-5/16"	1-915-2B	24.23	21.81
1,200-2,000	5"	1-3/16"	16	4-5/16"	1-915-3B	31.40	28.26

COILHOSE PNEUMATICS Filter, Regulator, and Lubricator Trios

Heavy-duty filter, regulator, and lubricator trio assemblies provide valuable time savings when installed.

FEATURES:

- Compact assembly.
- Faster installation time.
- Gauge packaged uninstalled for installation on either side.
- Plastic bowl is standard on filters and lubricators.
- These units also come standard with a gauge.
- Standard on regulators



Pipe Size (NPT)	Heavy-Duty Trios		
	Part No.	Reg. Net Price	SALE!
1/4"	1-816-8882AAG	\$393.04	\$334.08
3/8"	1-816-8883AAG	393.04	334.08

iGAGING® IP54 EZ-Depth Drill Press DRO

FEATURES:

- Easy to read LCD display.
- On/Off button.
- Incremental function.
- Auto shut off.
- Universal fit.
- Double rail mounting brackets included.
- CR2032 Battery included.
- Installation parts and tool included.

Part No. 1-815-805
Reg. Net Price \$76.89

\$69.20

SPECIFICATIONS:

Range.....0-5"/125 mm
Resolution.....0.0005"/0.01 mm/ 1/64"
Accuracy.....0.001"





Machinist Clamping Set

Stud Size: 1/2"-13
Table T-Slot Size: 5/8"

SET INCLUDES:

- (6) Serrated End Clamps
- (24) Studs, 4 Each:
3", 4", 5", 6", 7", 8" lg.
- (6) T-Slot Nuts
- (6) Flange Nuts
- (4) Coupling Nuts
- (6) Step Blocks
- (1) T-Slot Cleaner



Supplied with a plastic case.

Part No. **1-904A-20402** **\$228⁸¹**
Reg. Net Price \$269.19



Pull-Action Latching Toggle Clamp



Model	Height to Center Line	OAL	Drawing Movement	Holding Cap. (lbs.)	Part No.	Reg. Net Price	SALE!
330	9/16"	5-11/16"	2-3/8"	200	1-910-53300	\$39.82	\$35.84
351	5/16"	8-11/16"	4"	375	1-910-53510	30.42	27.38
381	1/2"	13-1/4"	6-1/8"	1,000	1-910-53810	95.42	85.88

Great Neck Quick Ratcheting Bar Clamp & Spreader

FEATURES:

- Easy conversion from clamp to spreader.
- Strong lightweight construction.
- Nylon fiber-filled jaws and a steel shaft for strength, light weight, and durability.
- Push button jaw release.



Bar Length	Part No.	Reg. Net Price	SALE!
6	1-909-59000	\$20.12	\$17.10
12	1-909-59001	22.42	19.06
18	1-909-59002	27.16	23.09
24	1-909-59003	30.76	26.15

Star Type Hand Knobs



- Made of cast iron.
- Black finish.

Thread Size	Head Dia.	Part No.	Reg. Net Price	SALE!
1/4-20	1"	1-397-316	\$3.12	\$2.65
5/16-18	1-1/2"	1-397-317	4.60	3.91
3/8-16	2"	1-397-318	4.94	4.20
1/2-13	2-1/2"	1-397-319	8.05	6.84
5/8-11	3"	1-397-320	9.05	7.69

Threaded Rods

PLAIN OIL FINISH

FEATURES:

- 1 meter lengths.
- Coupling nuts can be used to make longer lengths.
- High quality low carbon steel.



METRIC THREADED ROD

Size	Pitch	Part No.	Reg. Net Price	SALE!
M6	1.00	1-919-068	\$9.40	\$8.46
M8	1.25	1-919-070	9.64	8.68
M10	1.50	1-919-072	13.56	12.20
M12	1.75	1-919-074	19.24	17.32
M14	2.00	1-919-076	27.11	24.40
M16	2.00	1-919-078	36.10	32.49
M20	2.50	1-919-080	56.39	50.75

NATIONAL FINE THREADS

Size	Threaded Per Inch	Part No.	Reg. Net Price	SALE!
#10	32	1-919-022	\$7.35	\$6.62
1/4"	28	1-919-024	3.56	3.20
5/16"	24	1-919-026	10.18	9.16
3/8"	24	1-919-028	11.15	10.04
7/16"	20	1-919-030	19.60	17.64
1/2"	20	1-919-032	15.77	14.19
5/8"	18	1-919-034	21.90	19.71
3/4"	16	1-919-036	33.24	29.92
7/8"	14	1-919-038	43.61	39.25
1"	14	1-919-040	61.00	54.90

NATIONAL COARSE THREADS

Size	Threaded Per Inch	Part No.	Reg. Net Price	SALE!
#10	24	1-919-003	\$13.68	\$12.31
1/4"	20	1-919-004	3.48	3.13
5/16"	18	1-919-006	4.42	3.98
3/8"	16	1-919-008	6.46	5.81
7/16"	14	1-919-010	12.64	11.38
1/2"	13	1-919-012	11.08	9.97
5/8"	11	1-919-014	17.73	15.96
3/4"	10	1-919-016	26.28	23.65
7/8"	9	1-919-018	38.19	34.37
1"	8	1-919-020	47.97	43.17



20 Pc. Steel Poc-Kit Feeler Gage Assortment

FEATURES:

- Each blade marked with thickness.
- Rounded ends and smooth edges for safety.



INCH 1/2" x 5"

Sizes (1 Each): .001", .0015", .002", .003", .004", .005", .006", .007", .008", .009", .010", .012", .014", .015", .016", .018", .020", .022", .024", & .025"

Part No. **1-958-19740** **\$53⁵⁸**
Reg. Net Price \$63.04

METRIC 12.7 x 127mm

Sizes (1 Each): .05, .10, .15, .20, .25, .30, .35, .40, .45, .50, .55, .60, .65, .70, .75, .80, .85, .90, .95, & 1.00mm

Part No. **1-958-09740** **\$87⁶²**
Reg. Net Price \$103.08

Machinery's Handbook

31st Edition

[Click here for more details.](#)

For more than 100 years, Machinery's Handbook has been the most popular engineering resource of all time. Universally considered the principal reference in the manufacturing and mechanical industries, the Handbook is the ultimate collection of essential information needed by engineers, designers, drafters, metalworkers, toolmakers, machinists, educators, students, and serious home hobbyists. From engineering and design departments, machine and metalworking shops, and a wide range of manufacturing and industrial facilities, to countless classrooms and workshops worldwide, this is the must-have technical reference.

TABLE OF CONTENTS:

- Mathematics Mechanics & Strength of Materials
- Properties, Treatment, & Testing of Materials
- Dimensioning, Gaging, & Measuring
- Tooling & Toolmaking
- Machining Operations
- Manufacturing Processes
- Fasteners
- Threads & Threading
- Gears, Splines, & Cams
- Machine Elements
- Measuring Units

Toobox Edition (4.6" x 7")

Part No. **1-961-05531**
Reg. Net Price \$227.75
\$193⁵⁹

Large Print (7" x 10")

Part No. **1-961-06531**
Reg. Net Price \$284.71
\$242⁰⁰

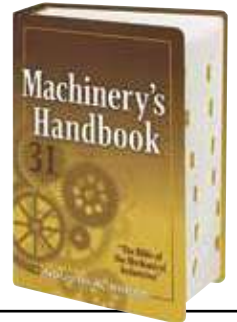

KANT-TWIST Universal Clamps

FEATURES:

- Designed to eliminate distorting or twisting action.
- Copper plated jaws and screws are ideal for welding.
- Floating jaws that always stay parallel.
- Built-in V-blocks for round or rod stock.



Combination of the best features of ordinary c-clamps and parallel clamps!

Size & Style	Max. Opening	Throat Depth	Rated Load	Part No.	Reg. Net Price	SALE!
1" T Handle	1-1/16"	1/2"	350	1-532-401	\$35.04	\$29.78
2" T Handle	2"	1-1/8"	800	1-532-405	49.50	42.08
3" T Handle	3"	1-1/4"	1500	1-532-410X	79.00	67.15
4-1/2" D - Deep Throat	4-1/2"	2-1/4"	1700	1-532-415	84.37	71.71
6" D - Deep Throat	6"	4-1/2"	2000	1-532-421	122.09	103.78

200 Pc. Screw Assortment Set

SET INCLUDES:

- (10) #5-40 x 3/16".
- (10) #8-32 x 3/16".
- (10) #10-24 x 1/4".
- (30) 1/4"-20" x 1/4".
- (20) 1/4"-28NF x 1/4".
- (20) 1/4"-20" x 3/8".
- (30) 5/16"-18" x 3/8".
- (20) 5/16"-24NF x 3/8".
- (20) 5/16"-18" x 1/2".
- (10) 3/8"-16" x 3/8".
- (10) 3/8"-24NF x 3/8".
- (10) 3/8"-16" x 1/2".



Part No. **1-928-AS99** **\$44³⁴**
Reg. Net Price \$52.16





SAWZIT™
PURE SYNTHETIC
SAWING LUBRICOOLANT

FEATURES:

- Amazing, new transparent lubricoolant that can handle your toughest metalworking applications, and *it does not contain sulfurs, chlorine, nitrates, mineral oil or heavy duty salts.*
- Doesn't attack paint, exotic metals, bearings or pumps.
- Stable & odor free; non smoking and non fogging in use, with no residual contamination of the work place.
- Biodegradable and exhibits excellent safety with ease of disposal. When properly cleaned of tramp oils and metal fines, residual should be compatible with local codes. Users must consult and comply with local regulations.
- Not recommended for Aluminum.



WATER SOLUBLE!

5 Gallon Pail
Part No. **1-123-080**
Reg. Net Price \$173.49
\$156¹⁴



Rustlick™ WS-5050 Water Soluble Oil

Water-soluble oils combine oil with emulsifiers to create an oil-based coolant concentrate designed for water dilution that provides the lubricity of straight oils with the cooling and flushing abilities of water.

Suited for all types of machining, this fluid can be used on all metals except titanium. It is compatible with CNC machining, and its effective E.P. additive provides excellent tool life. Special additives protect neoprene seals.

Quality heavy-duty water-soluble oil with chlorinated EP additives.

5 Gallon Pail
Part No. **1-122-74056**
Reg. Net Price \$431.43
\$388²⁹



NON-OZONE DEPLETING

Shaft Type Coolant Pumps

FEATURES:

- Can be adapted for use on any machine requiring coolant.
- These pumps are used on most standard machines - lathes, bandsaws, grinders, etc.
- Perfect replacements for worn-out, burnt-out pumps on your machines.
- Deluxe Models are all metal construction.
- Economy Models feature plastic housing.

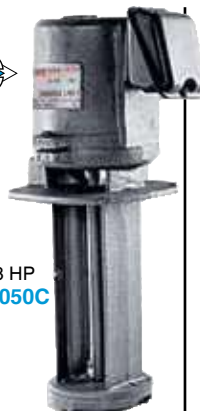

3-Phase, 220V/440V, 1/8 HP
Part No. **1-456-050**
Reg. Net Price \$240.04
\$204⁰³

3-Phase 575V, 1/8 HP
Part No. **1-456-050C**
Reg. Net Price \$264.75
\$225⁰⁴

sure shot® A1000 Sprayer
32 oz. Capacity

Anything an aerosol sprays SURE SHOT sprays safer!

FEATURES:

- Refillable and rechargeable.
- Environmentally safe.
- No Ozone depleting tax.
- Do not use water or water-based materials in steel sprayers.
- Not recommended for paint.
- Working Pressure: 80-150 PSI.



INCLUDES:

- 32 oz. Steel Interior, Green Exterior Sprayer.
- 2 Interchangeable Nozzles.

Part No. **1-541-060**
Reg. Net Price \$130.14
\$110⁶²



KOOL MIST

60M-12 PORTAMIST Only

Includes 1 delivery line.

Part No. **1-437-565**
Reg. Net Price \$252.25
\$214⁴¹



KOOL MIST

Mist or Flood Coolant

Formula 77 for Tougher Service

1 Gallon Plastic Bottle
Part No. **1-437-771**
Reg. Net Price \$101.71
\$91⁵⁴



For mist and flood cooling. Highly recommended where tougher machining conditions require greater lubricity, where material is very abrasive, or tool pressure is exceptionally great.

DYKEM BRITE-MARK® Markers

Dykem's popular marker, features a medium tip for clear, bold markings.

Dykem Color	Part No.	Reg. Net Price	NOW!
Dark Blue	1-442-M1	\$7.68	\$6.91
Black	1-442-M2	7.68	6.91
White	1-442-M3	7.68	6.91
Yellow	1-442-M4	7.68	6.91
Orange	1-442-M5	7.68	6.91
Red	1-442-M6	7.68	6.91
Green	1-442-M7	7.68	6.91

FEATURES:

- Drying Time: 25 - 35 seconds.
- Bullet tips are replaceable to ensure complete use of paint in each marker.
- Value actuated mechanism prevents paint in barrel from drying when cap is left off.
- Formula is not xylene-based.
- Make permanent bright marks on metal, rubber, plastic, glass, concrete, leather, stone, wood, vinyl, and more.
- Heavy duty aluminum body with large paint capacity.



Milwaukee M12™ Stick Transfer Pump

FEATURES:

- Equipped with HydroPass™ Filter to shield against clogs. 360° filter maximizes flow in heavy debris.
- Eliminate repetitive manual pumping.
- Head Height: up to 15 feet.
- 3/4" outlet attaches to standard garden hose.
- 36" submersible barrel for easier inlet control.
- Threaded filter designed for easy removal.
- Compatible with all M12™ batteries.

NEW!



Model No. 2579-20
Part No. **1-828-2579-20**
\$249⁰⁰



SPECIFICATIONS:
Gallons Per Hour 540 (9 GPM)
Dimensions 48.8" x 3.6" x 3.6"
Voltage 12V

LOCTITE® 242™ Threadlocker

Medium Strength / Blue

For fasteners between 1/4" & 3/4" diameter.

FEATURES:

- Applied to threaded components before assembly, it has controlled lubricity for accurate clamp loads.
- Parts can be separated using hand tools.



Bottle Size	Part No.	Reg. Net Price	SALE!
10 ml	1-444-24221	\$26.04	\$22.13
50 ml	1-444-24231	82.99	70.54

LittleGIANT® Parts Washer Pump

FEATURES:

- Submersible pump for use with standard solvent and deodorized kerosene submerged parts washer applications only.
- Sealed unit has double-lip Viton® seal and nylon head.
- Cast aluminum housing.
- 1/4" MNPT discharge.
- 6" power cord with master builders conduit fitting.
- Thermally protected.



Model 1-Y5
Part No. **1-440-501020**
Reg. Net Price \$371.73
\$315⁹⁷

GENERAL E-Z Ratchet Tubing Cutter

FEATURES:

- Wide hardened flared clearance grooved rollers allow true cuts close to flared end tubing.
- Ratcheting action rotates the cutter around the tube allowing use in close quarter applications.
- Spare cutting wheel supplied in handle.
- Longer handle requires less effort.
- Comes with RW122 tool steel cutting wheel for use on copper, aluminum, other thin wall tubing, and iron pipe.
- Cuts cooper, brass, aluminum tubing and thin wall conduit.
- Replaceable cutting wheels: RW121/2, RW122, RW122P



1/8" to 1-1/8" Capacity
Part No. 1-805-133
 Reg. Net Price \$41.27 **\$35⁰⁸**

CHANNEL LOCK Long Nose Pliers

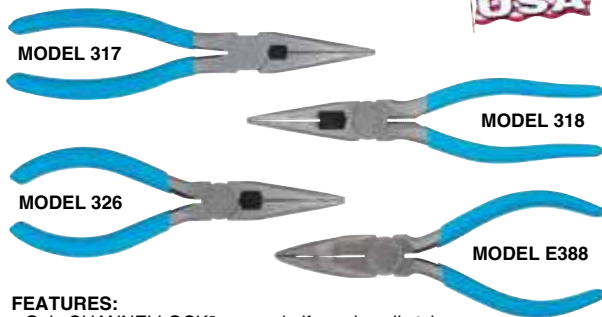

FEATURES:

- Only CHANNELLOCK® uses a knife and anvil style edge to ensure perfect mating and superior cutting edge life.
- High carbon C1080 steel for superior performance on the job and an electronic coating for ultimate rust prevention.
- Laser heat-treated cutting edges with crosshatch pattern on jaws.
- CHANNELLOCK BLUE® grips for comfort.

Model No.	OAL	Description	Part No.	ONLY!
317	8"	With Cutter	1-820-317G	\$46.33
318	8"	With Heavy Duty Cutter	1-820-318	47.81
326	6.10	With Cutter	1-820-326	45.12
E388	8"	With Bent Nose	1-820-386	49.11

12 Pc. Screw Extractor Set

For removing broken screws, bolts, studs, and pipes. Sizes: #1 to #6.



Supplied in a plastic case.

Part No. 1-397-6718
 Reg. Net Price \$34.05 **\$28⁹⁴**

IP65 6" Digital Torpedo Level

FEATURES:

- Reversible reading.
- HOLD and Zero functions.
- Rare-Earth magnetic base.
- Precision digital level sensor.
- Calculate tilt percentage rate.
- V-groove base for measuring cylindrical objects.
- Rechargeable battery (USB charging cable included).
- Large LCD display with backlight.
- Industrial grade aluminum body.
- IP65 water & dust resistance rating.
- 1 year warranty.



SPECIFICATIONS:
 Measuring Range 360° 90° x 4
 Resolution 0.05°
 Repeatability 0.1°
 Accuracy ±0.2°
 Dimensions 6 x 1.18 x 2.46"

Part No. 1-815-210
 Reg. Net Price \$137.95 **\$103⁴⁶**

WISE-GRIP® 7 Pc. Fast-Release™ Locking Plier Set



Vise-Grip® Fast Release™ Locking Tools have a 20% reduced hand span and a one-handed, triggerless Fast Release™ mechanism that makes opening twice as quick and 3x more gripping power, with no slipping or stripping. More control, better comfort, and less fatigue.

FEATURES:

- Redesigned tactile grip zone helps improve user control and is suited for high temperature applications.
- Hex key adjusting screw tightens to adjust pressure and draws materials together, providing a more controlled release.
- Built with heat treated alloyed steel for maximum durability.
- One-handed, triggerless release that is 2X easier to open.

Set Includes:
 10R®, 7R®, 10CR®
 7WR®, 6LN®, 5WR®, 9LN®
Part No. 1-820-82595
 Reg. Net Price \$355.22

\$248⁶⁵

Milwaukee 4 Pc. Pry Bar Set



The pry bar's all-metal core improves durability. A hammer-ready strike cap protects the tri-lobe handle from damage and improves your ability to work in tight places. Each metal pry bar has a comfortable tri-lobe handle and features a durable chrome finish for superior corrosion resistance and easy cleaning. The pry bar tool set comes with an easy-access storage tray.

FEATURES:

- I-Beam design for more prying strength.
- All-metal core for durability.
- Hammer-ready strike cap.
- Comfortable tri-lobe handles.
- Chrome finish for corrosion resistance.



Model No. 2579-20
 Sizes Included:
 8", 12", 18", & 24"

Part No. 1-828-48229214

\$74⁹⁹

Milwaukee 4 Pc. Hook and Pick Set



This set features a straight pick, offset hook, o-ring hook, and 90° right angle hook to give you versatility for a variety of mechanic and automotive uses. Set supplied in an easy-access storage tray.

SET INCLUDES:

- (1 Each):
 • Straight Pick.
 • Offset Hook.
 • O-Ring Hook.
 • 90° Right Angle Hook.

FEATURES:

- All-metal core for durability.
- Chrome plated for rust protection.
- Comfort grip handle.
- Knurling for increased tool control.



Model No. 48-22-9215

Part No. 1-828-48229215

\$21⁹⁷

BONDHUS 2 Pack GorillaGrip® Fold-Up Hex Tool Set



FEATURES:

- ProTanium™ is up to 20% stronger, with more torque and twice the wear resistance of standard grades of steel.
- Patented Durable GorillaGrip® handle is stronger than steel handles and the design makes every job faster and easier.
- Precision cut and chamfered tip ensures full tool engagement in the screw.

SET INCLUDES:

- (7) - 2, 2.5, 3, 4, 5, 6, 8mm
- (9) - 5/64", 3/32", 7/64", 1/8", 9/64", 5/32", 3/16", 7/32", 1/4"

Part No. 1-927-12522
\$23³¹



Drill Doctor Precision Drill Bit Sharpener
The Drill Bit Sharpener

Restore a full range of bits to like-new sharpness in less than 60 seconds!

- INCLUDES:**
- 180 Grit Wheel.
 - User's Guide.
 - Instructional DVD.
 - Storage Bag.

- FEATURES:**
- Custom points from 115° to 140°.
 - Sharpens 3/32"-3/4" high-speed steel, masonry, carbide, and TiN-coated bits.
 - Creates split-point bits from standard bits.
 - Adjustable Material Take-Off (MTO) - Fine-tune the sharpening process, touch-up a slightly dull bit, or deep grind for a heavily damaged bit.
 - Quick Change diamond sharpening wheel is long-lasting and easy to replace after several hundred sharpenings (no tools needed).
 - E-Z Align System™ for correct sharpening alignment.



3 Year Warranty!

Model DD750X
Part No. **1-817-DD750X**
Reg. Net Price \$252.72
\$232⁵⁰

AIRCAT 8" Low Vibration Pneumatic Tools® Air Saw

NEW!



- FEATURES:**
- 9,500 strokes/minute motor provides fast cutting action.
 - Internal damping system reduces the vibration level to 2.5m/sec².
 - Metal blade retainer increases reliability.
 - Rotational 360° rear exhaust muffler allows exhaust air to be directed as preferred.
 - Short overall length and low weight provides easier access and comfortable operation.
 - Cutting Capacity: 3/16" steel plate - 18 gauge.
 - Includes 18, 24, and 32 teeth power saw blades.

Model No. 6350
Part No. **1-830-050**
\$204⁰⁷

- SPECIFICATIONS:**
- No. Load Speed 9,500 RPM
 - Air Consumption 4 CFM
 - Air Inlet 1/4" NPT
 - Hose Size 3/8"
 - Tool Weight 1.13 lbs.

FPXair BY FLORIDA PNEUMATIC

3/8" Air Ratchet

- FEATURES:**
- Built-in forward/reverse switch in ratchet head.
 - High polished aluminum housing design.
 - Reliable single pawl ratchet head design.

Model FPX-500
Part No. **1-829-904**
Reg. Net Price \$89.84
\$76³⁶



NEW!

- SPECIFICATIONS:**
- Square Drive 3/8"
 - No Load Speed 200 RPM
 - Max. Torque 55 ft./lbs.
 - Air Consumption 4 CFM
 - Air Inlet 1/4" NPT
 - Air Pressure 90 PSI
 - Min. Hose Size 3/8" ID
 - Tool Length 10.25"

Milwaukee M12™ FUEL 1/4" Hex Impact Driver

NEW!

M12 FUEL™ 1/4" hex impact driver is the fastest subcompact impact driver, the most compact, and provides maximum workspace visibility. The POWERSTATE™ Brushless motor delivers the fastest driving speeds in the subcompact class for unmatched productivity. Tri-LEDs surround the bit accessory with brighter lights and less shadows providing maximum workspace visibility. REDLINK PLUS™ intelligence delivers top of the line thermal performance allowing more work to be completed.

- FEATURES:**
- POWERSTATE™ brushless motor delivers up to 1,500 in.-lbs. of torque.
 - REDLINK PLUS™ intelligence provides the ability to drive more fasteners back-to-back.
 - 5" length for access to most tight spaces.
 - 4-Mode drive control with dedicated self-tapping screw mode.
 - Light weight for tool belt portability and less fatigue in the workday.
 - Single handed bit insertion.
 - Compatible with all M12™ batteries and chargers.



Model No. 3453-20
Part No. **1-828-3453-20**
\$178⁰⁰

- SPECIFICATIONS:**
- Max. Torque 1,500 in.-lbs.
 - Chuck Type 1/4" Hex Quick Change
 - Impact Rate 0-4,000 IPM
 - No Load Speed 0-3,600 RPM
 - Dimensions 5" x 6.8" x 2.1"
 - Tool Weight 1.6 lbs.

PALMGREN POWERGRIND-XP™ 8" Variable Speed Bench Grinder With Dust Collection

NEW!



- FEATURES:**
- Equipped with the latest technology variable speed inverter delivering a broad range of continuous speeds to fit any application.
 - Powerful, heavy-duty capacitor motors provide additional torque and provide plenty of power at all speeds without any loss of RPM's at full load.
 - Extended wheel to wheel clearance.
 - Exclusive single port dust collection.
 - Press the high or low switch button on touch pad to variably adjust the speed up or down in 100 RPM increments.
 - LED speed readout with "soft" touch on/off.
 - Adjustable safety eye shields and spark guards.
 - Dynamically balanced rotors and sealed bearings.

3 YEAR

OSHA

Model No. 82097
Part No. **1-549-82097**
Reg. Net Price \$1,422.35
\$1,280¹²

- SPECIFICATIONS:**
- Wheel Diameter 8"
 - Motor 1 HP, 115/230V, 1 PH
 - Max. Speed 900-3,600 RPM
 - Arbor Size 5/8"

Milwaukee 7" / 9" Angle Grinder With Lock-on

NEW!

- FEATURES:**
- Powerful 4 HP, 15 AMP motor delivers 6,000 RPM for faster grinding.
 - The tool-free burst resistant guard allows the user to quickly adjust the guard without the use of a tool. Both a 7" & 9" Type 27 grinding guard are included.
 - Spiral bevel gearing optimizes performance and durability.
 - Ergonomic Handles: Angled rear and side handles promote natural hand positions and increase user comfort.
 - 3-position side handle attaches in 3 locations to maximize user control.
 - 2-finger trigger switch offers convenience for continuous-use applications.
 - 2-in-1 Versatility: Converts to a sander for greater tool utility.
 - 9' 2-Wire fixed rubber cord has durable construction for longer tool life.



- SPECIFICATIONS:**
- AMPS 15
 - Capacity 7" or 9"
 - No Load Speed 6,000 RPM
 - Spindle Thread 5/8"-11
 - Max. Horsepower 4 HP
 - Cord Length 9'
 - Tool Length 19-1/4"
 - Tool Weight 13.7 lbs.

Model No. 6088-30
Part No. **1-828-6088-30**
\$310⁰⁰

- INCLUDES (1 Each):**
- 15 Amp 7"/9" Large Angle Grinder with Lock-on.
 - Flange.
 - Spanner Wrench.
 - Type 27 Guard.

EVOLUTION® 1-5/8" Magnetic Drill

NEW!

- FEATURES:**
- Simple to use coolant system ensures that the workpiece stays cool while drilling.
 - Textured, Tri-spoke spindle handle gives you ultimate control when lowering the drill.
 - Ultra-smooth dovetail slides offer smooth and precise operation.
 - 2 stage magnet allows you to configure the machine so you get a perfect result.
 - Supplied with an 8 ft. rubber power cord.

- INCLUDES:**
- Keyed Chuck.
 - Chuck Adaptor.
 - Chuck Key.
 - Safety Guard & Fixing Screws.
 - Safety Strap.
 - 3 Piece Handle.
 - (4) Hex Keys.
 - Cooling Fluid Bottle & Tube.
 - Instruction Manual.
 - Carrying Case.

- SPECIFICATIONS:**
- Max. Annular Cutting Capacity 1-5/8"
 - Drill Capacity 1/2"
 - Max. Cutting Depth 2"
 - Min. Plate Thickness 3/8"
 - Cutter Shank 3/4"
 - Magnet Dimensions 1-5/8" x 3-1/2" x 7-1/8"
 - Drill Travel 11-1/2"
 - Magnetic Adhesion 2,860 lbs./f
 - No Load Speed 450 RPM
 - Motor 120V, 60Hz, 10 Amps

Model EVOMAG42
Part No. **1-827-425K**
\$923⁵⁵

\$221.65 Value!



- INCLUDES:**
- (1 Ea.) 7/16, 9/16, 11/16, 13/16, 15/16, & 1-1/16" at 1" Depth.
 - (2 Ea.) 1/4" x 3" OAL Pilot.

SHOP WHENEVER, WHEREVER FROM THE CONVENIENCE OF YOUR DEVICE



Download the KBC Tools Mobile App TODAY!



24/7 All Tools... All The Time.



24/7 PICK-UP LOCKERS

Check out the big red lockers outside our KBC Mississauga location. Just order during regular business hours and pick up your order anytime!

Your tools... your time.

3 LOCATIONS TO SERVE YOU!

Showroom Hours: Monday to Friday 8am - 5pm



Toronto Maritimes to Saskatchewan

6200 Kennedy Rd., Unit #1
Mississauga, ON L5T 2Z1
Local Calls (905) 564-6600
Fax Main Line .. (905) 564-1611



Windsor Windsor to London

5080 O'Neil
Oldcastle, ON N0R 1L0
Local Calls (519) 737-7000
Fax Main Line .. (519) 737-7682

Vancouver British Columbia & Alberta

108-1538 Cliveden Ave.
Delta, BC V3M 6J8
Local Calls (604) 540-4060
Fax Main Line .. (604) 540-4080



EVOLUTION evolutionpowertools.com

7-1/4" Metal Cutting Chop Saw With Stamped Steel Base

NEW!

Model EVOSAW185HD Part No. 1-827-415K

\$289⁰¹

FEATURES:

- Robust stamped steel base.
- Quick release vise for fast clamping.
- Accurate & durable cast steel vise with 0-45° miter capacity.
- Lightweight, compact design with head lock down chain for greater mobility.
- Chip deflector for a cleaner, safer working environment.
- Small and convenient for use in small workspaces.
- Supplied with a 6.5 ft. rubber power cord.

INCLUDES:

- 7-1/4" Mild Steel Blade with 44 Teeth (185BLADEST).
- Hex keys: 3mm, 5mm, & 6mm.
- Speed Handle.
- Dust Extraction Port.
- Carbon Brush Set.
- Instruction Manual.



PLUS!

INCLUDES:

- (1) 1-711-BK110: BEARKAT Clear Lens Safety Glasses.
- (1) 1-909-830: KBC Carbide Scriber.
- (1) 1-909-007: KBC Baseball Cap.
- (1) 1-397-600S: KBC Blow Gun.
- (6) 1-613-742: KBC 1-1/2" Chip Brush.

\$50.00 Value!

FREE KBC TOOLING KIT

Shop ALL Evolution Power Tools with Free KBC Kits!

KORLOY

APXT Coated Carbide Inserts

85° APXT Parallelogram 11° Positive Rake

GRADE PC-5300: For milling of steel. Tough sub-micron substrate. Has low coefficient of frictions to prevent built-up edge.

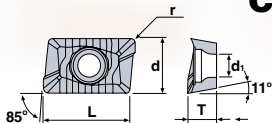

Insert Style	L	d	T	r	d1	Part No.	Reg. Net Price	SALE!
APXT 1035PDSR-MM	0.407"	0.263"	0.12"	0.020"	0.112"	6-APX-200	\$23.07	\$18.46
APXT 1604PDSR-MM	0.650	0.376	0.227	0.031	0.175	6-APX-210	28.56	22.85

save 20%

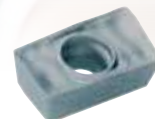

TAP MAGIC

Cutting Fluid With EP-XTRA®

For Drilling, Tapping, Milling... All Cuts on All Metals!

An ozone-friendly, professional quality cutting fluid that delivers superior performance for any cutting operation on any metal. Proprietary additive, EP-XTRA®, provides synergistic boost in performance.

Description	Part No.	Reg. Net Price	SALE!
4 oz. Spout Top	1-444-10004E	\$6.79	\$5.77
16 oz. Spout Top	1-444-10016E	22.12	18.80
1 Gallon Can	1-444-10128E	128.45	109.18

NON-OZONE DEPLETING



Milwaukee

M18™ Compact Brushless 1/2" Hammer Drill/Driver

NEW!

The compact hammer drill is lightweight allowing for excellent control, especially while working in overhead or tight spaces. The brushless motor was built to ensure optimal tool performance. REDLINK™ Intelligence paired with REDLITHIUM™ M18™ batteries ensures efficient power delivery resulting in less downtime recharging batteries. The cordless compact hammer drill has premium components with an all-metal gear case and 1/2" metal chuck providing the durability that professionals require.

FEATURES:

- Compact design provides excellent balance and control, ideal for overhead applications or work in tight spaces.
- REDLINK™ Intelligence: Advanced overload protection defends against heavy duty applications and monitors the temperature to prevent damage and ensure maximum tool and battery life.
- All-metal gear case and 1/2" metal chuck provides maximum impact and shock durability.
- Brushless motor delivers the power to quickly complete most common applications.
- Hammer drill function.

SPECIFICATIONS:

Voltage 18V
Chuck Type Metal
No Load Speed (2) ... 550 RPM / 1,700 RPM
Torque 550 in./lbs.
Blows Per Minute 0 - 25,500 BPM
Tool Length 5.8"
Tool Weight 2.3 lbs.



Model No. 3602-20
Part No. 1-828-3602-20
\$188⁰⁰

315 Pc. Roll Pin Assortment Set

SET INCLUDES:

- (10) 1/16" x 3/16"
- (10) 1/16" x 5/16"
- (10) 5/64" x 1/4"
- (10) 5/64" x 1/2"
- (10) 5/64" x 1"
- (10) 3/32" x 5/8"
- (10) 3/32" x 1"
- (10) 3/32" x 1-1/4"
- (15) 1/8" x 5/8"
- (15) 1/8" x 1"
- (15) 1/8" x 1-1/4"
- (10) 5/32" x 5/8"
- (10) 5/32" x 1"
- (10) 5/32" x 1-1/2"
- (15) 3/16" x 5/8"
- (15) 3/16" x 1"
- (15) 3/16" x 1-1/4"
- (10) 7/32" x 5/8"
- (10) 7/32" x 1-1/4"
- (10) 7/32" x 1-3/4"
- (10) 1/4" x 5/8"
- (10) 1/4" x 1-1/4"
- (10) 1/4" x 1-3/4"
- (10) 5/16" x 3/4"
- (10) 5/16" x 1-1/2"
- (10) 5/16" x 2"
- (5) 3/8" x 3/4"
- (5) 3/8" x 1-1/2"
- (5) 3/8" x 2"



MADE IN THE USA

Part No. 1-928-RP99 \$56⁶⁵
Reg. Net Price \$66.65

WEB: KBCTools.com

PHONE: 5 2 2 8 6 6 5
1-888-KBC-TOOL

FAX: 1-800-668-5615

